

Casa Las Palmas

Sample Floor Plan – Wedding Reception (60 people)

Parks & Recreation

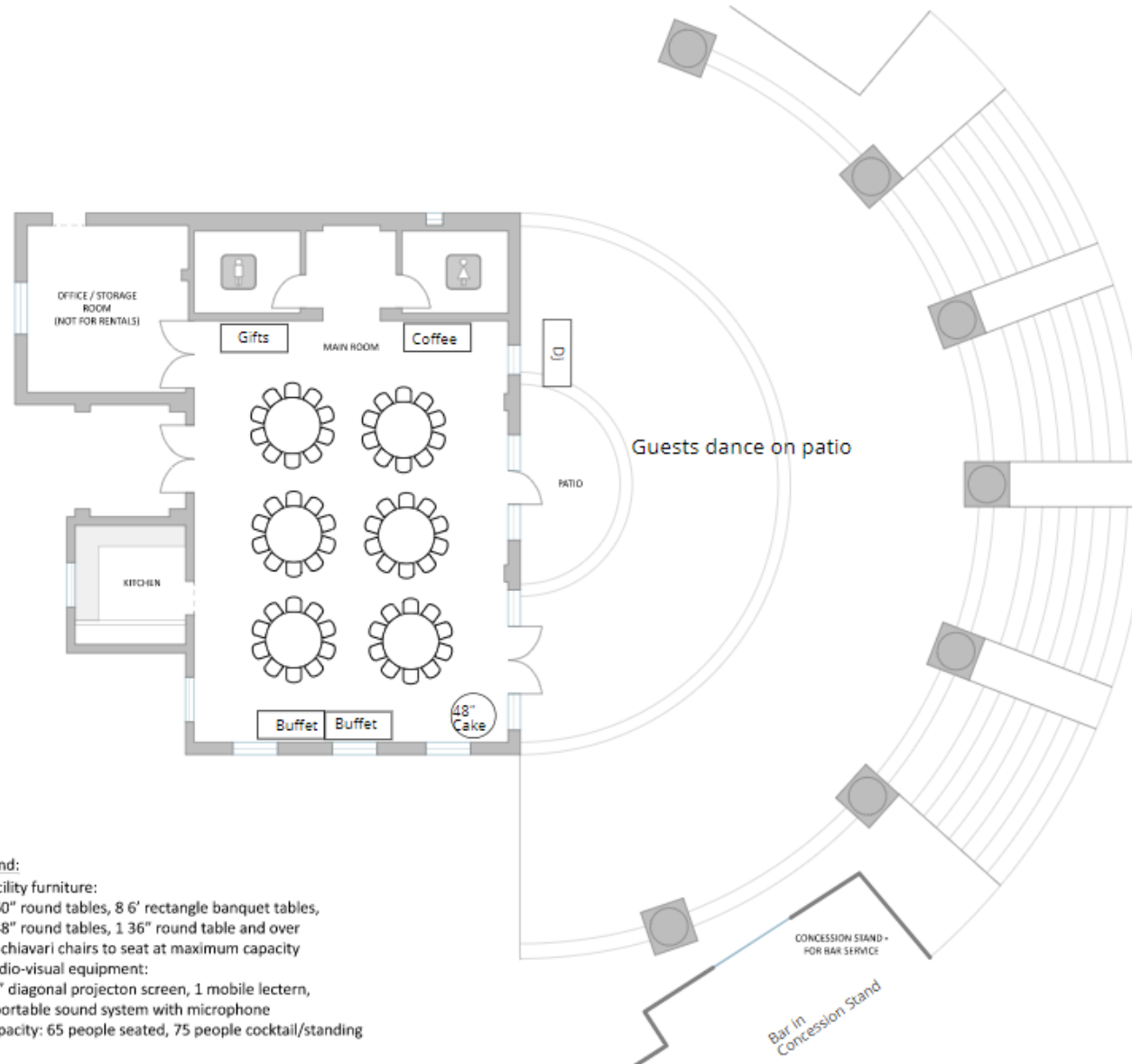

Legend:

- Facility furniture:
8 60" round tables, 8 6' rectangle banquet tables,
3 48" round tables, 1 36" round table and over
65 chiavari chairs to seat at maximum capacity
- Audio-visual equipment:
90" diagonal projection screen, 1 mobile lectern,
1 portable sound system with microphone
- Capacity: 65 people seated, 75 people cocktail/standing

Casa Las Palmas

Sample Floor Plan – Classroom (40 people)

Parks & Recreation

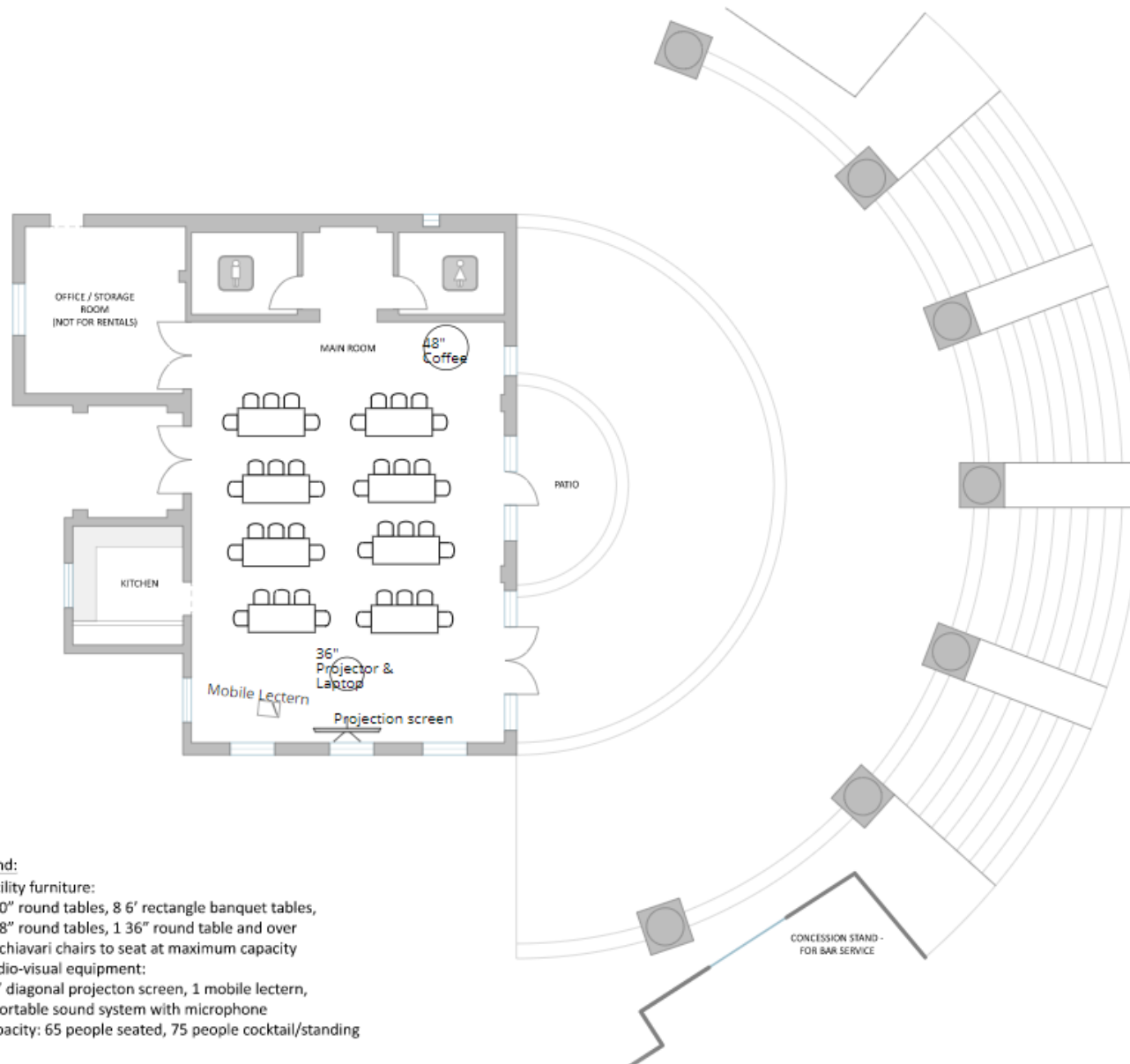

Legend:

- Facility furniture:
 - 8 60" round tables, 8 6' rectangle banquet tables,
 - 3 48" round tables, 1 36" round table and over
 - 65 chiavari chairs to seat at maximum capacity
- Audio-visual equipment:
 - 90" diagonal projection screen, 1 mobile lectern,
 - 1 portable sound system with microphone
- Capacity: 65 people seated, 75 people cocktail/standing

Casa Las Palmas

Sample Floor Plan – Meeting (31 people)

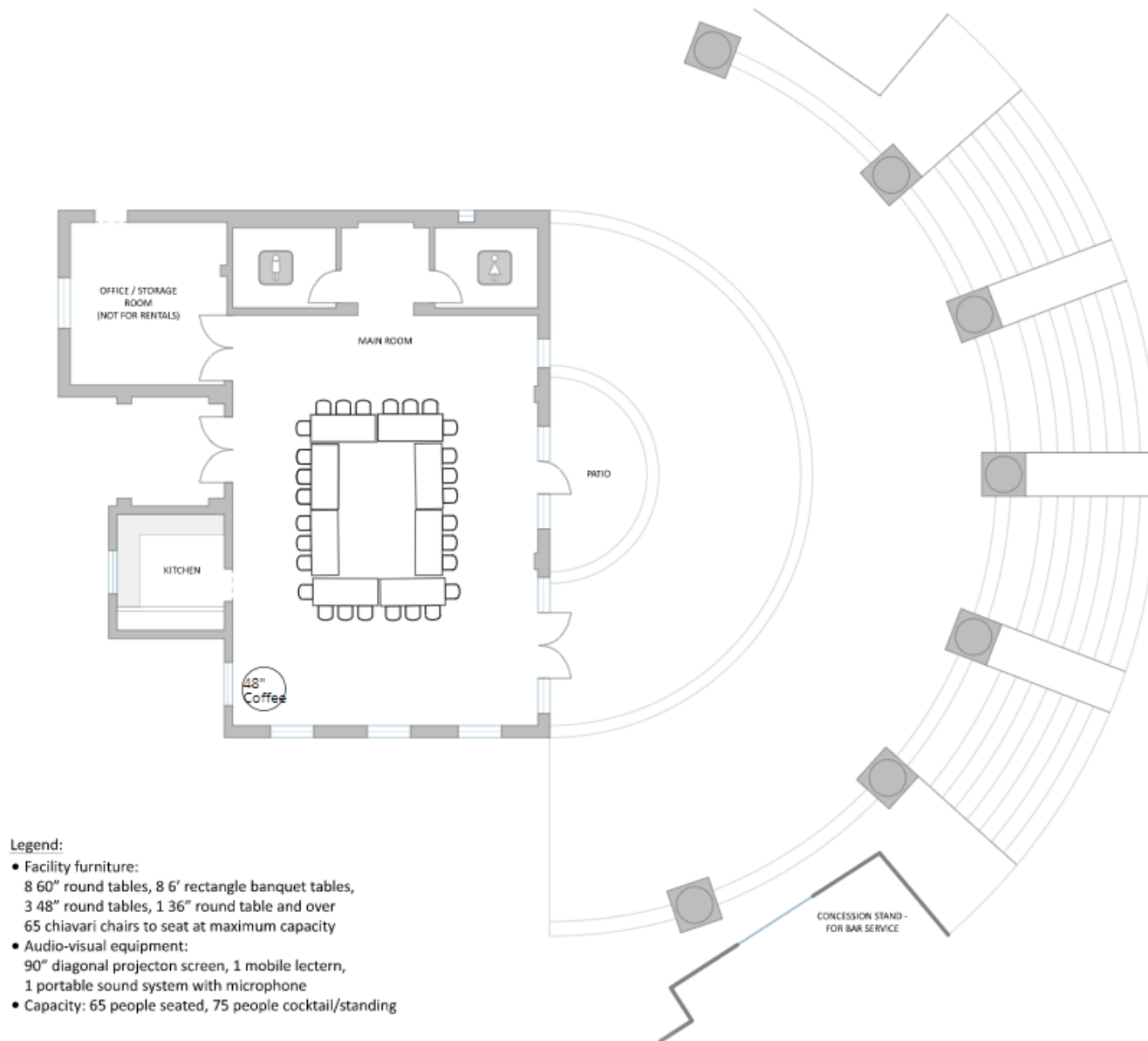

Casa Las Palmas

Sample Floor Plan – Theater (65 people)

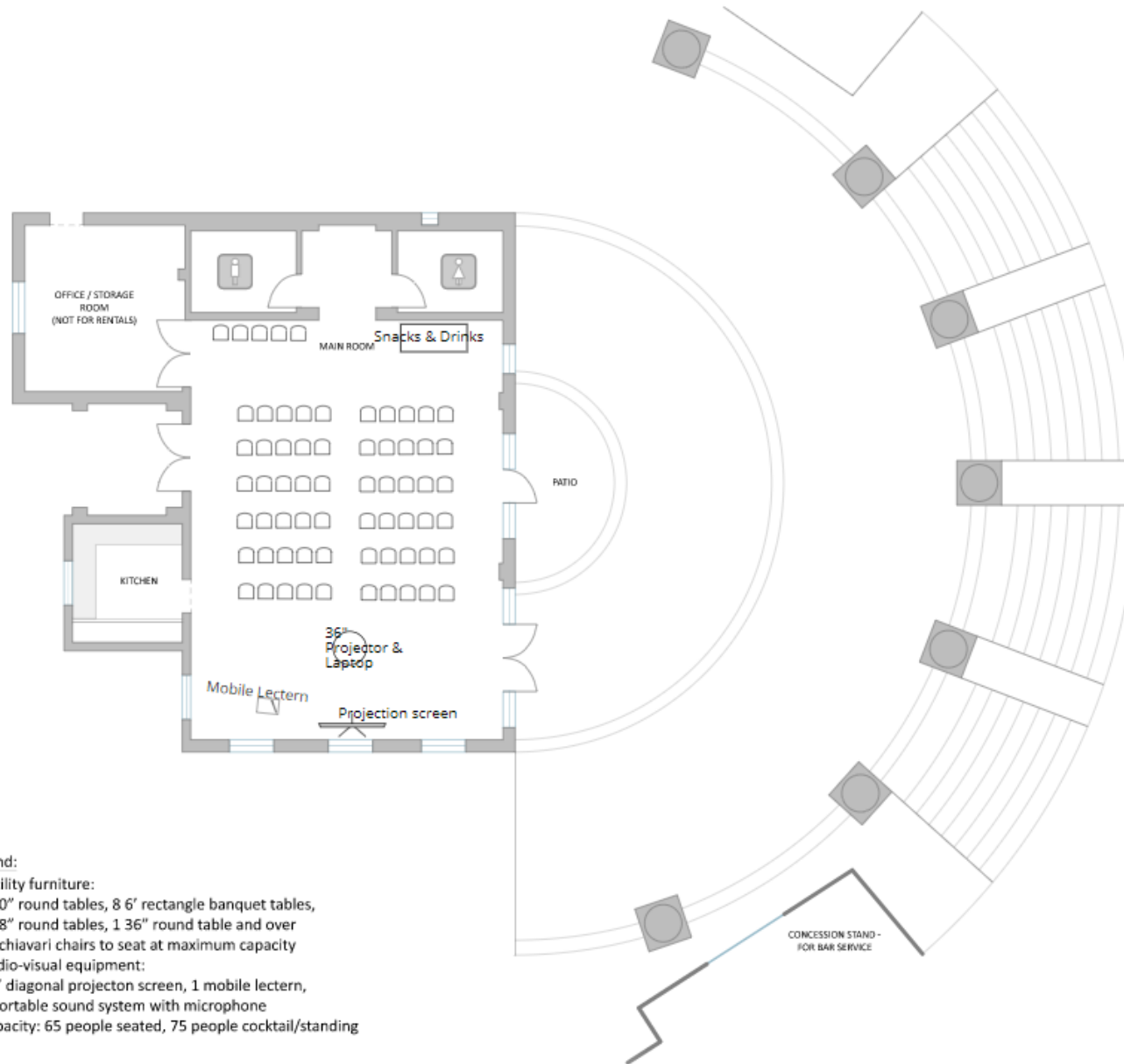

Legend:

- Facility furniture:
8 60" round tables, 8 6' rectangle banquet tables,
3 48" round tables, 1 36" round table and over
65 chiavari chairs to seat at maximum capacity
- Audio-visual equipment:
90" diagonal projection screen, 1 mobile lectern,
1 portable sound system with microphone
- Capacity: 65 people seated, 75 people cocktail/standing