

PUBLIC WORKS DEPARTMENT
630 GARDEN STREET • 564-5388
RECYCLED WATER PORTABLE METER APPLICATION SHEET

COMPANY / CONTRACTOR:	
MAILING ADDRESS:	
CITY:	STATE/ZIP:
SITE(S) OF USE*:	
TYPE OF USE:	
EMAIL:	
PHONE #:	PERMIT: PBW20 -
BUSINESS LICENSE #:	VEHICLE LICENSE#

* Use back of sheet if necessary

I, the undersigned, do assume responsibility for, and guarantee payment of, all water use incurred at the above site of use. I agree to comply with all rules, regulations, and ordinances related to City water and sewer service as established by the City, including, but not limited to:

- a) **Water obtained via authority of this permit cannot be re-sold to any private entity or used outside of City water service area.**
- b) No person shall take water from a recycled water fill station without first obtaining a permit from the Director of the Public Works Department. All water obtained via permit shall be metered. All metered use shall be paid for at rates set forth in the City Fee Resolution.
- c) No such permit holder shall take or use water contrary to this chapter or the terms of this permit.
- d) No such permit holder shall remove, tamper or otherwise cause the meter not to function as intended.
- e) No permit shall be issued to a person who has violated any of the provisions of this chapter or whose indebtedness to the City for water used, or damage to fill stations or equipment is delinquent.
- f) Permit holder shall designate the location(s) for which the water shall be used.
- g) Permit holder shall estimate the amount of water needed for the project.

Water Use Estimate

Truck Capacity =		
Number of Days Needed for Project =		
Number of Fills Needed Per Day =		
Total Estimated Use =		

REPRESENTATIVE SIGNATURE: _____

NAME (PRINT): _____

FEES (per current City fee resolution)

Deposit (incl mag/vinyl signs)	\$1800.00	Cash / Check (circle one)
Application Fee	\$45.36	(Incl. 8% Tech Fee)
Installation Inspection Fee	\$76.68	(Incl. 8% Tech Fee)
Metered Water Rate	\$3.02	per Hundred Cubic Feet
Damaged Meter Fee	\$100.00	minimum

DATE INSTALLED: ____ / ____ / ____

RECYCLED METER #: _____ INITIAL METER READ: _____

Customer has received training for employee safety and allowed site use of recycled water? Yes No
 Customer has received magnetic or adhesive signs and installed them on the truck. Yes No



**City of Santa Barbara
Public Works Department
630 Garden Street – 564-5388
Recycled Water Truck Permit**

This Use Permit must be available for inspection at all times. The recycled water User / User's Agent must carry a copy in the tanker truck at all times and present it to City of Santa Barbara Inspectors upon request.

Effective Date of Permit: _____ Expiration Date: _____

USER INFORMATION

NAME OF USER _____ PHONE: _____

ADDRESS _____

USER AGENT INFORMATION

USER AGENT (if different from above) _____ PHONE: _____

ADDRESS _____

A Recycled Water Truck Permit must be filled out for each portable construction meter and retained at the site and on the User/User's Agent vehicle. Users and User's Agents shall adhere to the attached Guidelines for Worker Protection, use and site constraints regarding the use of tertiary treated recycled water.

RECYCLED WATER USE INFORMATION

NOT TO BE USED FOR STORM DRAIN FLUSHING

VOLUME OF RECYCLED WATER AUTHORIZED: _____ Gallons per Day

APPLICATION METHOD: TANK TRUCK SPRAY WASH WATER OTHER: _____

USE OF THE WATER: COMPACTION DUST CONTROL IRRIGATION SEWER FLUSHING
 STREET CLEANING OTHER: _____

SIGNAGE REQUIRED: TRUCK (3) PROJECT SITE COMMENTS: _____

WHERE APPLIED:

ADDRESS: _____ START DATE: _____

ADDRESS: _____ START DATE: _____

ADDRESS: _____ START DATE: _____

CERTIFICATION

I hereby certify under penalty of perjury that the information provided in this application and in any attachments is true and accurate to the best of my knowledge. I also certify that I have read and agree to abide by all applicable rules and regulations of the RWQCB Order 2009-0006-DWQ and per SBMC 14.23. Making unauthorized connections is prohibited and is a misdemeanor. Purple meter to recycled water fill station only. SBMC 1.25.070 allows for a maximum penalty of \$250 per incident.

SIGNATURE OF USER _____ PRINT _____ TITLE _____ DATE _____

SIGNATURE OF USER'S AGENT _____ PRINT _____ TITLE _____ DATE _____

**GUIDELINES FOR WORKER PROTECTION
(Regional Water Quality Control Board – Recycled Water Guidelines)**

- A. Workers should be informed that although recycled water has been treated to lower health risks, bacterial and viral contamination is still present and potentially may cause illness or infection. Contact with recycled water by ingestion, inhalation of mist, or on cuts or abrasions should be avoided, and the precautionary measures listed below should be carefully reviewed and followed.
- B. Precautionary measures should be taken to minimize worker contact with constituents of recycled water.
 - 1. Workers should not be subjected to recycled water sprays, mists, or aerosols.
 - 2. Workers should be protected with protective clothing when there will be more than casual contact with the recycled water.
- C. Safe drinking water should be supplied for workers. Where bottled water is provided, the water should be in contamination-proof containers and protected from recycled water and dust.
- D. Hand washing facilities should be provided consisting of potable water supply, hand washing soap, and single use sanitary paper towels. The importance of hand washing should be stressed when working with recycled water, especially before eating or smoking.
- E. Workers shall wear proper personal protective equipment when applying recycled water by hand held nozzles or other hand held devices that can produce sprays, mists, or aerosols.
- F. Precautions should be taken to avoid contamination of food taken into recycled water use areas. Food should not be taken into areas still wet with recycled water.
- G. Workers should be notified that recycled water is in use. Notification should include the posting of conspicuous warning signs with proper wording of sufficient size to be clearly read. In those locations where English is not the primary language of the workers, the signs should be in the appropriate language as well as in English.
- H. An adequate first aid kit should be available on location. Cuts or abrasions should be promptly washed, disinfected, and bandaged.
- I. Public contact with recycled water shall be avoided, to the extent practical, under the normal use at the recycled water site.
- J. In all areas where recycled water is used that are accessible to the public, warning signs shall be installed at adequate intervals around the use area as required by the District.
- K. Recycled water shall not be applied where it could contact walkways, passing vehicles, buildings, drinking water facilities, storm drains, or enter areas where food is handled or eaten.
- L. Adequate measures shall be taken to prevent ponding, and to prevent run off of recycled water from the authorized recycled water use area unless it is specifically allowed by the RWQCB or an attachment to this Permit.
- M. Spray of recycled water shall not be allowed to contact an external drinking water fountain.
- N. There shall be no irrigation or impoundment of recycled water within a minimum of 50 feet of any water well.
- O. Distributor's vehicles used for transportation and distribution of recycled water must have water tight valves and fittings, and must not leak, and tanks must be cleaned of contaminants prior to use. A truck or tank that has contained material from a septic tank or cesspool shall not be used to convey recycled water.
- P. Distributor's vehicles that convey recycled water shall be clearly labeled in a prominent location with language stating in English "Recycled Water Do Not Drink".

- Q. Recycled water shall not be put into piping or a storage facility without specific written authorization from City of Santa Barbara, Public Works Director.
 - R. Recycled water shall be applied at a rate and volume not to exceed vegetative demand and soil moisture conditions needed to leach excess salts to below the root zone.
 - S. Recycled water shall not be used for irrigation during periods of extended rainfall and/or runoff.
-

I HAVE READ AND UNDERSTOOD THESE GUIDELINES.

USER _____ PRINT _____ DATE _____

USER AGENT _____ PRINT _____ DATE _____

TRUCK CONVERSION FOR RECLAIMED WATER
OBTAIN METER AND APPURTENANCES FROM THE WATER RECLAMATION INSPECTOR

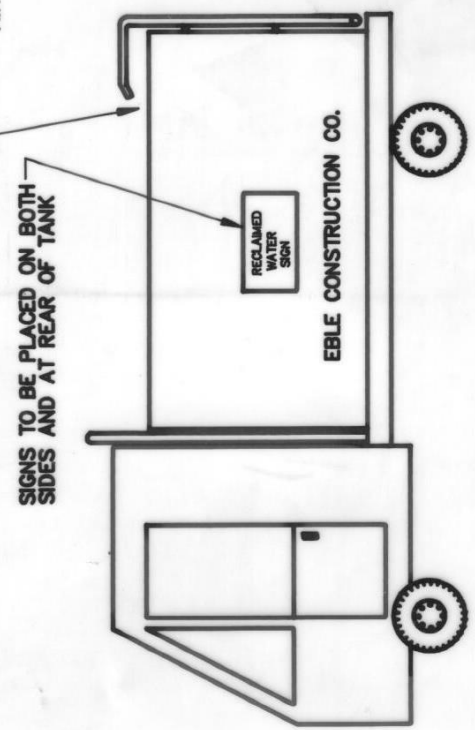
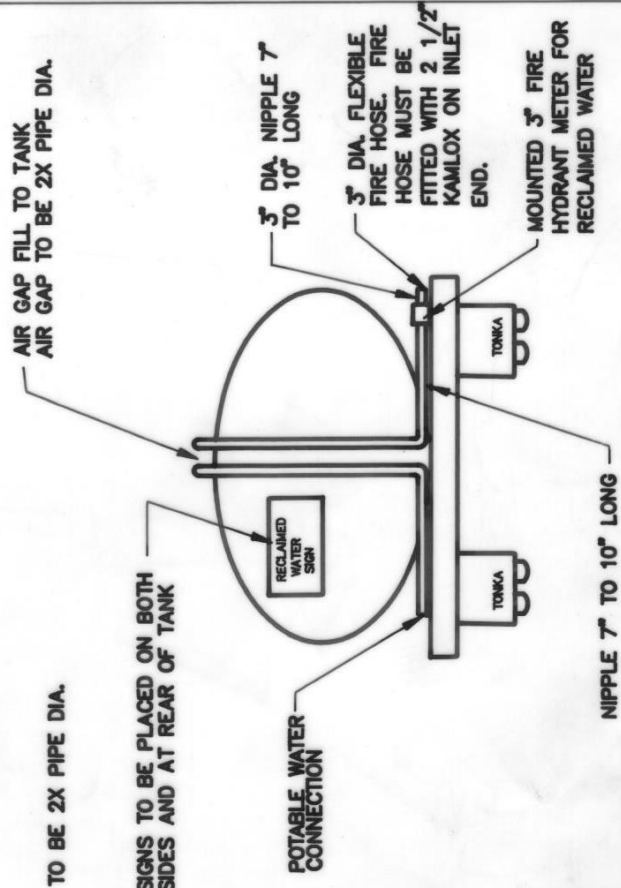

**City of Santa Barbara
Trucked Recycled Water Log**

Truck Owner: _____
Vehicle License # _____
Recycled Water Meter # _____

Date	Project Name	Location of use	Before reading	After reading	Quantity (Gallons)	Driver Signature



City of Santa Barbara
Public Works Department
Recycled Water Fill Stations

Recycled water is available as an alternative to using potable water from City fire hydrant meters for construction projects. The cost for use of recycled water is roughly 60% less than for potable water. Additionally, using recycled water saves valuable potable water and helps conserve our water supply for drier times.

There are 11 fill stations throughout the City. Detailed site maps are available and general locations are shown below.

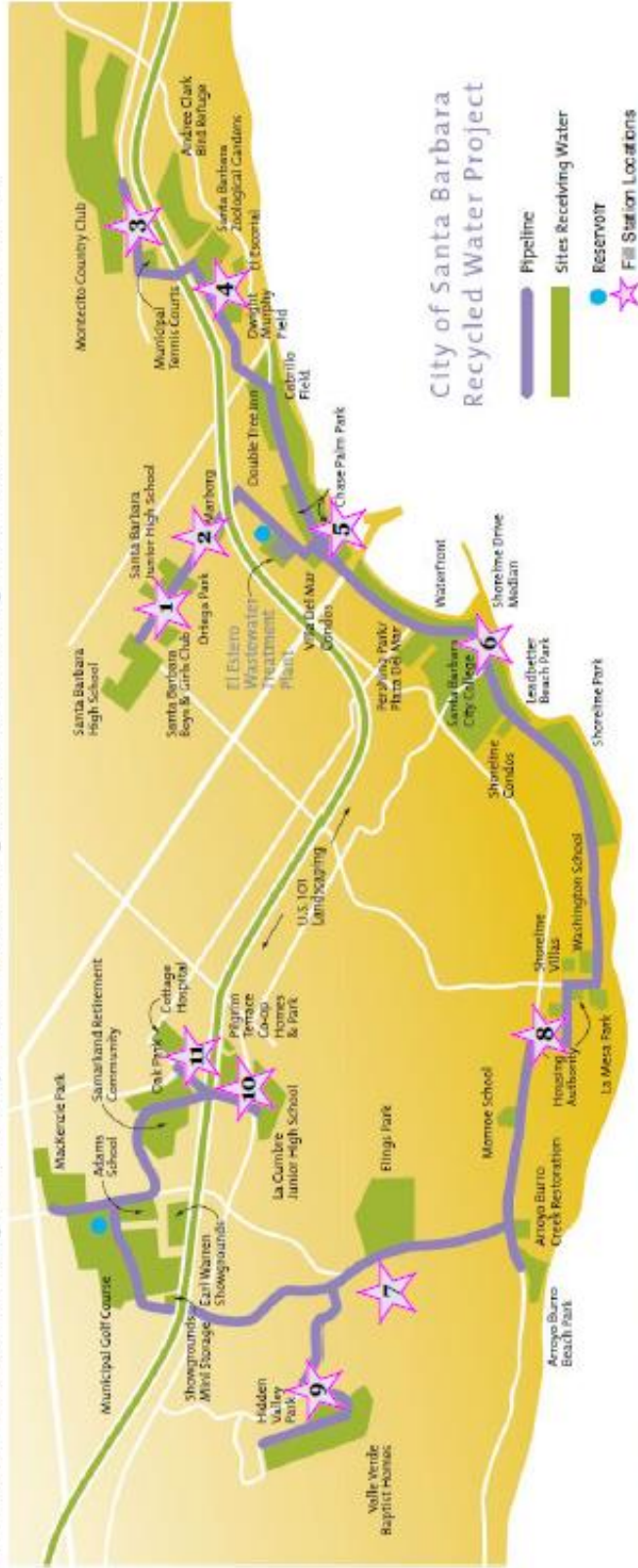

In order to use recycled water for construction purposes:

1. Complete the "Recycled Water Meter Permit Application for Construction" and submit to the Public Works Counter at 630 Garden St.
2. Contact the Recycled Water Inspector at 564-5575 or 564-5406 to arrange for meter pickup, training and signage.
3. Submit readings to the Recycled Water Inspector on the 15th of each month.

FOR MORE INFORMATION: www.santa-barbara.ca.gov/recycled-water

Public Works Permit Counter • 630 Garden Street, Santa Barbara CA 93101 • (805) 564-5388