



Calle Real

Traffic & Engineering Survey Summary

From / To	Las Positas Road to W. Pueblo Street
FAU Classification	Urban Minor Arterial
Width	38 Feet
Length	2470 Feet
Striping, Parking and Land Use	Double Yellow Center Line, Two-Way. Pueblo Street to Junipero Street, Parking on Both sides. Junipero to Las Positas, No Parking
Existing Posted Speed Limit	40 miles per hour (mph)
85th Percentile Speed	31.9 mph
Pace	23 to 33 mph
Average Daily Traffic	5,590
Special Characteristics	
Engineer's Determination of Speed Limit	30 miles per hour (mph)
Speed Survey Expiry Date:	6/19/2020
Date prepared 9/19/2013 JER	

City of Santa Barbara
Derrick Bailey P.E., T.E.
Supervising Transportation Engineer
Registered Civil Engineer Number C 65726

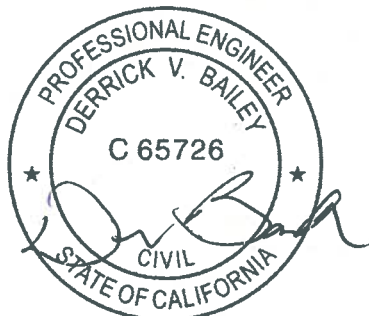

10.20.14

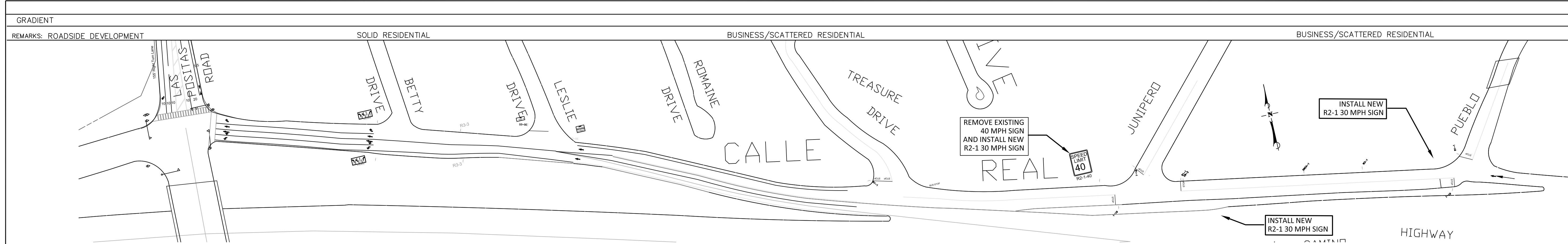

ROADWAY WIDTH	50' FEET	38' FEET	36' FEET
NO. OF STRIPED LANES	FOUR	TWO	TWO
TYPE OF DIVISION STRIPE	CHANNELIZING LINES	DOUBLE YELLOW CENTER LINE	DOUBLE YELLOW CENTER LINE
TRAFFIC SIGNAL DATA	ACTUATED	NONE	NONE
AVERAGE DAILY TRAFFIC		5,500	
OBSERVED SPEED CRITICAL		31.9 MPH	
OBSERVED SPEED 10 mph PACE		23 to 33 MPH	
EXISTING SIGNED ZONE		40 MPH	
PROPOSED SPEED LIMIT		30 MPH	

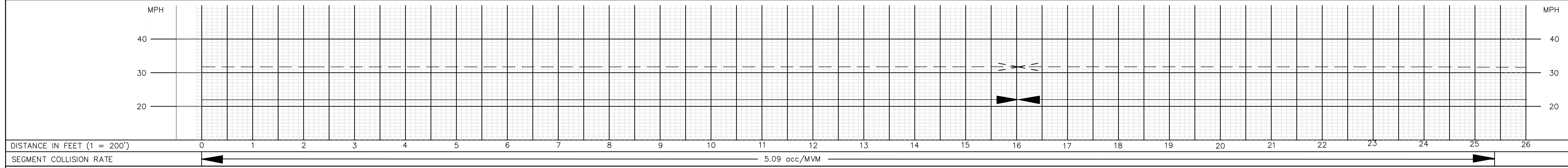

DISTANCE IN FEET (1" = 200')	0	1	2	3	4	5	6	7	8	9	10	11	12	13	14	15	16	17	18	19	20	21	22	23	24	25	26
SEGMENT COLLISION RATE																	5.09 acc/MVM										
2009 District 5 Urban 2 LN Accident Rate=																	(1.59 acc/MVM)										
2009 Statewide 3 yr 2 LN Accident Rate =																	(1.42 acc/MVM)										

CITY OF SANTA BARBARA

SPEED ZONE SURVEY
CALLE REAL

FROM Las Positas Road
TO E. Pueblo Street

SCALE: SCALE - 1" = 300'

DATE: 06-12-2013

PREPARED BY: J. ROUSSEAU

LEGEND

ROAD SIGNS

REGULATORY & WARNING (CODE NO.)

TRAFFIC SIGNALS

SENIOR CENTERS

SCHOOLS

CHURCHES

BLOCK ###

SPEED STUDY LOCATION

CRITICAL SPEED - 85%

LOWER LIMIT OF 10mph PACE



Calle Real

June 5, 2013

Pueblo to Las Positas - Both Directions

Posted Speed is 40 MPH

1 (mph)	2 ui	3 fi	4 fiui	5 % class	6 cumulative %	7 fi*ui^2	7 f(ui-u)^2
Speed Range	Class Midvalue	Frequency					
11-14	12	25	300	0.2%	0.2%	3600	90000
15-19	17	207	3519	1.9%	2.2%	59823	12383361
20-24	22	1460	32120	13.7%	15.9%	706640	1031694400
25-29	27	4776	128952	44.8%	60.6%	3481704	16628618304
30-34	32	3594	115008	33.7%	94.3%	3680256	13226840064
35-39	37	561	20757	5.3%	99.6%	768009	430853049
40-44	42	41	1722	0.4%	100.0%	72324	2965284
45-49	47	2	94	0.0%	100.0%	4418	8836
50-54	52	1	52	0.0%	100.0%	2704	2704
55-59	56	2	112	0.0%	100.0%	6272	12544
		10,669	302,636			8,785,750.0	31,333,468,546.0

$u = fiui/fi$

Total Volume	85 Percentile	Mean	Standard Dev.	Median	Skewness Index
10,669	31.9	28.4	4.3	27.9	0.97

10 mph Pace

23

mph to

33

mph

Prepared By

J Rousseau

Description 1: Calle Real 2412
 Description 2: Speed Survey
 Description 3: C3 Jun 2013

Site:
 Monday, 6/10/2013, 9:10:37 AM -
 Wednesday, 6/12/2013, 7:30:13 AM

Volume Grand Totals

Average Interval Volumes

	EB		WB		Combined			EB		WB		Combined	
12:00 AM	0.5	1.5	9.5	33.0	10.0	34.5	12:00 PM	7.0	30.0	128.5	395.5	135.5	425.5
12:15 AM	1.0		7.5		8.5		12:15 PM	10.0		92.5		102.5	
12:30 AM	0.0		12.0		12.0		12:30 PM	8.0		86.0		94.0	
12:45 AM	0.0		4.0		4.0		12:45 PM	5.0		88.5		93.5	
1:00 AM	0.0	0.5	4.5	15.0	4.5	15.5	1:00 PM	7.5	34.5	98.5	374.5	106.0	409.0
1:15 AM	0.5		2.0		2.5		1:15 PM	10.5		93.5		104.0	
1:30 AM	0.0		2.0		2.0		1:30 PM	9.5		90.5		100.0	
1:45 AM	0.0		6.5		6.5		1:45 PM	7.0		92.0		99.0	
2:00 AM	1.0	1.0	1.5	7.0	2.5	8.0	2:00 PM	10.5	35.0	92.0	380.5	102.5	415.5
2:15 AM	0.0		2.0		2.0		2:15 PM	8.5		93.0		101.5	
2:30 AM	0.0		2.0		2.0		2:30 PM	9.0		96.0		105.0	
2:45 AM	0.0		1.5		1.5		2:45 PM	7.0		99.5		106.5	
3:00 AM	0.0	0.0	0.5	5.5	0.5	5.5	3:00 PM	6.0	30.0	109.5	469.0	115.5	499.0
3:15 AM	0.0		1.0		1.0		3:15 PM	11.0		114.0		125.0	
3:30 AM	0.0		4.0		4.0		3:30 PM	6.5		126.0		132.5	
3:45 AM	0.0		0.0		0.0		3:45 PM	6.5		119.5		126.0	
4:00 AM	0.0	1.0	2.0	15.5	2.0	16.5	4:00 PM	10.5	37.5	128.5	506.0	139.0	543.5
4:15 AM	1.0		3.0		4.0		4:15 PM	11.5		124.0		135.5	
4:30 AM	0.0		4.5		4.5		4:30 PM	9.5		135.0		144.5	
4:45 AM	0.0		6.0		6.0		4:45 PM	6.0		118.5		124.5	
5:00 AM	0.5	3.5	2.5	31.0	3.0	34.5	5:00 PM	5.5	30.5	171.0	493.5	176.5	524.0
5:15 AM	1.0		6.5		7.5		5:15 PM	9.0		120.0		129.0	
5:30 AM	0.5		10.0		10.5		5:30 PM	8.0		114.5		122.5	
5:45 AM	1.5		12.0		13.5		5:45 PM	8.0		88.0		96.0	
6:00 AM	0.0	7.0	21.0	122.0	21.0	129.0	6:00 PM	4.0	12.5	77.0	265.0	81.0	277.5
6:15 AM	1.5		15.0		16.5		6:15 PM	2.0		71.0		73.0	
6:30 AM	2.5		37.0		39.5		6:30 PM	4.5		64.5		69.0	
6:45 AM	3.0		49.0		52.0		6:45 PM	2.0		52.5		54.5	
7:00 AM	4.0	26.4	37.0	219.0	41.0	245.4	7:00 PM	8.0	18.5	58.5	220.5	66.5	239.0
7:15 AM	4.5		44.0		48.5		7:15 PM	4.5		48.5		53.0	
7:30 AM	3.9		71.0		74.9		7:30 PM	3.5		65.0		68.5	
7:45 AM	14.0		67.0		81.0		7:45 PM	2.5		48.5		51.0	
8:00 AM	7.0	34.0	65.0	256.0	72.0	290.0	8:00 PM	2.5	10.5	44.0	148.0	46.5	158.5
8:15 AM	7.0		66.0		73.0		8:15 PM	1.5		33.5		35.0	
8:30 AM	8.0		62.0		70.0		8:30 PM	3.0		42.0		45.0	
8:45 AM	12.0		63.0		75.0		8:45 PM	3.5		28.5		32.0	
9:00 AM	5.4	22.4	61.1	280.1	66.6	302.6	9:00 PM	3.0	10.5	33.5	109.0	36.5	119.5
9:15 AM	7.0		73.0		80.0		9:15 PM	3.0		30.5		33.5	
9:30 AM	5.0		68.5		73.5		9:30 PM	2.5		22.5		25.0	
9:45 AM	5.0		77.5		82.5		9:45 PM	2.0		22.5		24.5	
10:00 AM	8.5	31.0	82.0	311.0	90.5	342.0	10:00 PM	2.5	5.0	21.0	77.0	23.5	82.0
10:15 AM	6.5		63.5		70.0		10:15 PM	1.0		19.5		20.5	
10:30 AM	8.5		83.0		91.5		10:30 PM	0.0		15.5		15.5	
10:45 AM	7.5		82.5		90.0		10:45 PM	1.5		21.0		22.5	
11:00 AM	8.0	27.0	82.0	374.0	90.0	401.0	11:00 PM	2.5	6.0	20.5	64.0	23.0	70.0
11:15 AM	6.0		79.0		85.0		11:15 PM	0.0		12.5		12.5	
11:30 AM	5.5		100.0		105.5		11:30 PM	2.0		20.0		22.0	
11:45 AM	7.5		113.0		120.5		11:45 PM	1.5		11.0		12.5	

	ADT	EB	WB	Combined
Study Volume Totals		415.9	5171.6	5587.5
		776	9907	10683
		7.3 %	92.7 %	

Calle Real - Las Positas Road to Pueblo Street

Segment length in feet	2,500	
Number of collisions =	12	See below.
AADT	5,590	
Time period in years =	3	01/01/2010 - 01/01/2012
Segment Collision rate =	6.21070	ACC/MVM
2009 District 5 Urban 4+UDV =	2.19	ACC/MVM
2009 Statewide 3 yr 4+UDV =	2.09	ACC/MVM

Crash Number

	CASE ID	STREET 1	STREET 2	COLL TYPE	DATE	TIME
1	4035179	CALLE REAL	LAS POSITAS RD	Broadside	1/24/2009	1:07
2	4268429	CALLE REAL	LAS POSITAS RD	Rear end	6/3/2009	12:08
3	4474965	CALLE REAL	LAS POSITAS RD	Rear end	11/9/2009	10:20
4	4565021	CALLE REAL	LAS POSITAS RD	Side swipe	1/11/2010	17:46
5	4562709	CALLE REAL	LAS POSITAS RD	Hit object	1/25/2010	0:30
6	4678483	RT 101	CALLE REAL	Rear end	4/13/2010	20:53
7	4856017	PUEBLO ST	CALLE REAL	Side swipe	8/26/2010	15:56
8	4921110	CALLE REAL	LAS POSITAS RD	Rear end	10/13/2010	15:30
9	4941736	CALLE REAL	LAS POSITAS RD	Rear end	10/17/2010	13:23
10	5352162	PUEBLO ST	CALLE REAL	Rear end	8/22/2011	11:20
11	5320706	CALLE REAL	LAS POSITAS RD	Side swipe	9/22/2011	13:50
12	12-72077	CALLE REAL	JUNIPERO ST	Rear end	9/28/2012	16:00