

**FRONT YARD SET BACK TREE REMOVAL  
REQUEST**

October 2017

*Date:* 9/19/17

*Requested by:* Eric Goodall

*Address:* [Egoodall@SantaBarbaraCa.gov](mailto:Egoodall@SantaBarbaraCa.gov)

*Location of Tree:* 3894 Pemm Place, Santa Barbara, CA 93110

*Tree Species:* *Washingtonia robusta*      *Common Name:* Mexican Fan Palm

*Zoning/Setback:* E – 3/SD – 2 20'/10' Setback

*Reason for Removal:* New sidewalk and ramp installation that conflict with the location of existing trees within public right of way.

*Proposed Replacement:* Yes  w/ *Jacaranda trees north and south of the new parkway.*      No

*Advisory Committee Recommendation:* *Conditionally Approve Removal:*       *Deny Removal:*

*Staff Recommendation:* *Conditionally Approve Removal:*       *Deny Removal:*

*Date Posted:* 10/11/17

*Comments:* The Committee (4/0) recommends that the Commission approve removal on the condition Public Works Engineering be required to plant up to two *Jacaranda* street trees.

**PHOTO INVENTORY**



SEP 19 2017

PARK & RECREATION  
PARKS DIVISION



**City of Santa Barbara  
Parks and Recreation Department**

**STREET TREE REMOVAL APPLICATION**

*Setback*

**Mailing Address:**  
PO Box 1990  
Santa Barbara, CA 93102  
(805) 564-5433 FAX (805) 897-2524

**Office Address:**  
402 E. Ortega St.  
Santa Barbara, CA 93101

Application Fee: \$50 (effective July 1, 2010)

<b>DATE OF REQUEST:</b>	9/14/2017
<b>APPLICANT:</b>	Eric Goodall
<b>ADJACENT OWNER NAME:</b> (IF DIFFERENT THAN APPLICANT):	City of Santa Barbara
<b>MAILING/EMAIL ADDRESS:</b>	<a href="mailto:Egoodall@SantaBarbaraCA.gov">Egoodall@SantaBarbaraCA.gov</a>
<b>DAYTIME PHONE:</b>	805-897-2664
<b>TREE LOCATION (Address):</b>	One at 3894 Pemm Place
<b>TREE SPECIES:</b>	Mexican Fan Palm
<b>REASON FOR REMOVAL:</b>	New sidewalk and ramp installation that conflict with the location of existing trees regardless of sidewalk location within public right of way.

**PROVIDE THE FOLLOWING SUPPLEMENTAL INFORMATION**

- Property owner letter, indicating reasons for removal. Also include whether:
  - The removal application is associated with new development or redevelopment of property
  - Status of development application, including whether the project is scheduled for review by the Single Family Design Board, Architectural Board of Review or Historic Landmarks Commission
  - The tree is a designated Specimen or Historic Tree
- Photo of tree(s) proposed for removal
- Development plan/Landscape plan

### **Property Owner Letter**

The North La Cumbre Sidewalk Infill Project will develop the previously undeveloped public right of way along the east side of La Cumbre Road from La Cumbre Hills Lane north to Pemm Place. The Project involves filling missing links of sidewalk and installation of rapid flashing beacons at Calle Cita and La Cumbre. The proposed sidewalk section is a five-foot walk separated from the curb by a 3.5ft parkway. The tree that has been identified in this request for removal is located such that it is in direct conflict with the proposed location of sidewalk installation at Pemm Place.

Please refer to drawing for exact location of tree for removal.

New Jacaranda trees can be installed in the new parkway located north and south of Pemm Place as allowed. It is anticipated that two Jacaranda can be planted in this location, provided the 3.5ft parkway width is sufficient for the tree root structure.

The Project will be presented to the Architectural Board of Review. The aforementioned tree to be removed is not a designated Specimen or Historic Trees.

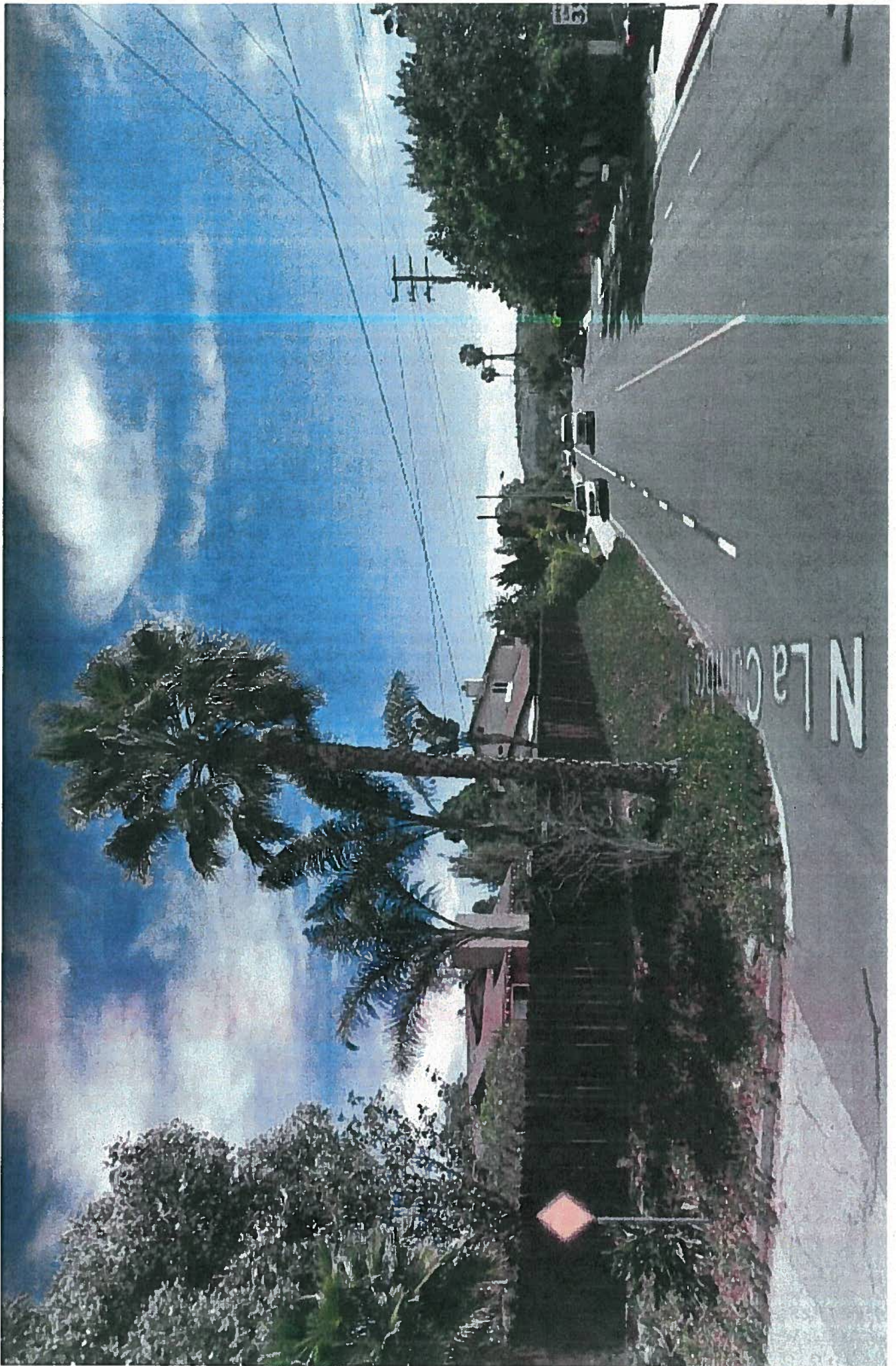

MEASURE A CYCLE 3 - SIDEWALK INFILL PROJECT  
**LA CUMBRE RD**  
**AT PEMM PLACE**

2016-01316	DATE
3840	C7
C-1-4800	PROJECT NUMBER
8 of 10	SHEET

DESIGN	DATE	APPROVED
DRAWN	DATE	APPROVED
CHECKED	DATE	APPROVED
CITY ENGINEER	DATE	APPROVED

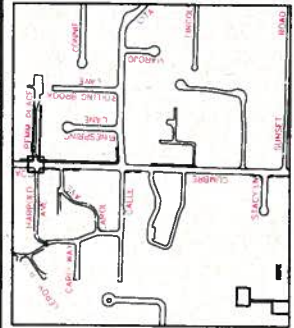

- GENERAL CONSTRUCTION:**
- CONSTRUCT CONCRETE SIDEWALK PER CITY STANDARD DETAILS H-010 AND H-011
  - CONSTRUCT CONCRETE ACCESS RAMP PER CITY STANDARD DETAIL H-012
  - RECONSTRUCT CONCRETE DRIVEWAY PER CITY STANDARD DETAIL H-013
  - RECONSTRUCT CONCRETE DRIVEWAY PER CITY STANDARD DETAIL H-011
  - INSTALL ASPHALT CONCRETE CONFORM
  - CONSTRUCT PORTLAND CEMENT CONCRETE CURB AND GUTTER PER CITY STANDARD DETAIL H-010
  - CONSTRUCT CONCRETE SHOULDER AND CROSS GUTTER PER CITY STANDARD DETAIL H-010
  - CONSTRUCT CONCRETE RETAINING CURB AS DIRECTED BY INSPECTOR. NOTES TO GRADE
  - CONSTRUCT CONCRETE RETAINING WALL PER DETAIL E/C4
  - CONSTRUCT RETURN WALL PER DETAIL F/C4
  - ADJUST BOX, FRAME, OR COVER TO GRADE
  - TRIM AND MATCH EXISTING STRUCTURE
  - PRESERVE AND PROTECT IN PLACE
  - REMOVE AND RECONSTRUCT
  - PAINT NEW RED CURB AND TOUCH UP EXISTING ADJACENT RED CURB
  - CLEAN AND OIL, REMOVE AND DISPOSE OF EX LANDSCAPE
  - THRU (NOT USED)

**STREET TREES & LANDSCAPE:**

- CONSTRUCT BIO-RETENTION BASIN PER DETAIL D/C4
- REMOVE EXISTING TREE
- REMOVE EXISTING TREE
- PLANT AND CARE TREE AS NEEDED
- THRU (NOT USED)

**LEGEND**

- CONCRETE CONSTRUCTION
- CONSTRUCT ASPHALT CONCRETE
- CONSTRUCT RETAINING WALL
- CONSTRUCT BIO-RETENTION BASIN
- MULCH AND GRADE TO MATCH
- EXISTING STRIPING
- NEW STRIPING
- CURB PAINT LIMITS
- EXIST. TREE



SCALE 1" = 10'

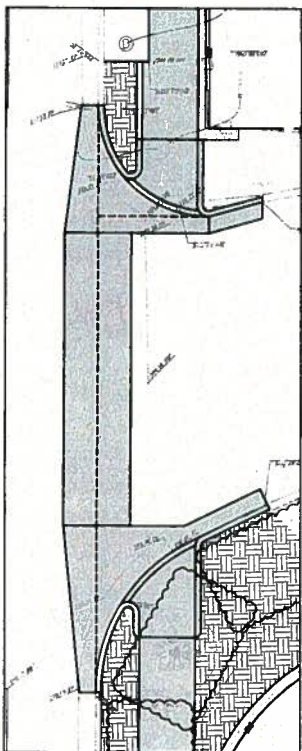
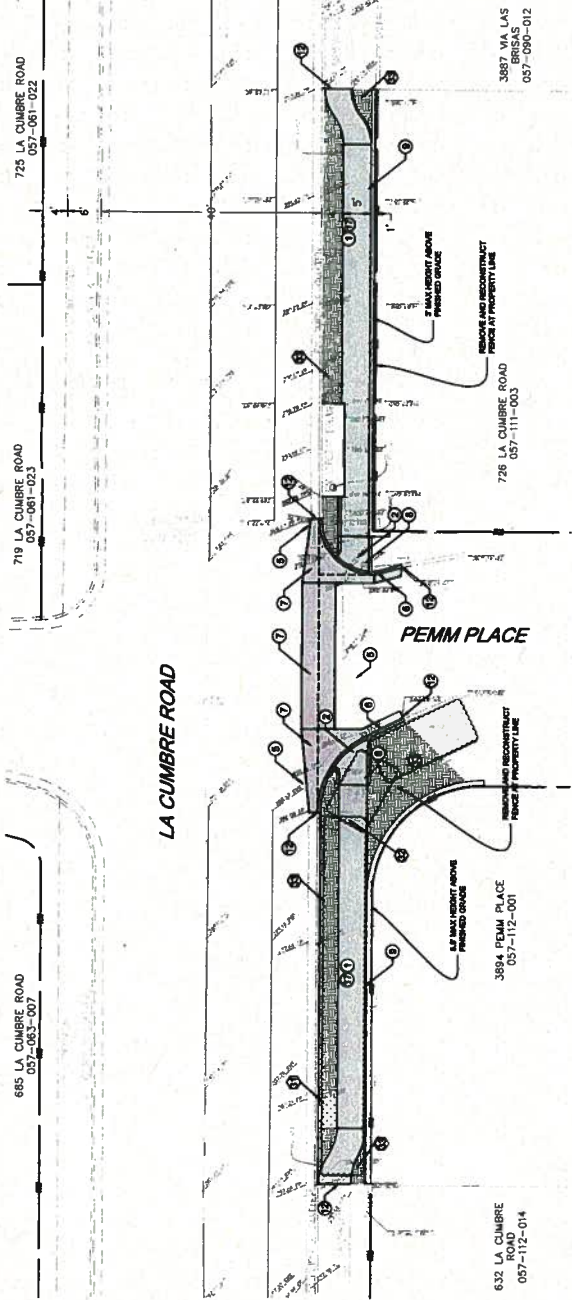

DATE

PROJECT NUMBER

Know what's below. Call before you dig.