

October 2014

Date: 9/24/14

Requested by: Courtney Miller, Landscape Architect

Address: 300 E. Canon Perdido St., #C-2, Santa Barbara, CA 93101

Location of Tree: 1330 Chapala St., Santa Barbara, CA 93101

Tree Species: (5) *Platanus racemosa* **Common Name:** California Sycamore

Requested Reason for Removal: Declining health.

Current designated Street Tree: *Cedrela fissilis*, Brazilian Cedar Wood, *Koelreuteria bipinnata*, Chinese Flame Tree - January 6, 2011

Advisory Committee Recommendation: *Conditionally Approve Removal:* *Deny Removal:*

Staff Recommendation: *Conditionally Approve Removal:* *Deny Removal:*

Date Posted: 10/9/14

Comments: The Committee (4/0) recommends that the Commission approve the removal of (5) trees on the condition the replacement trees be *Cedrela fissilis*, Brazilian Cedar Wood.

PHOTO INVENTORY



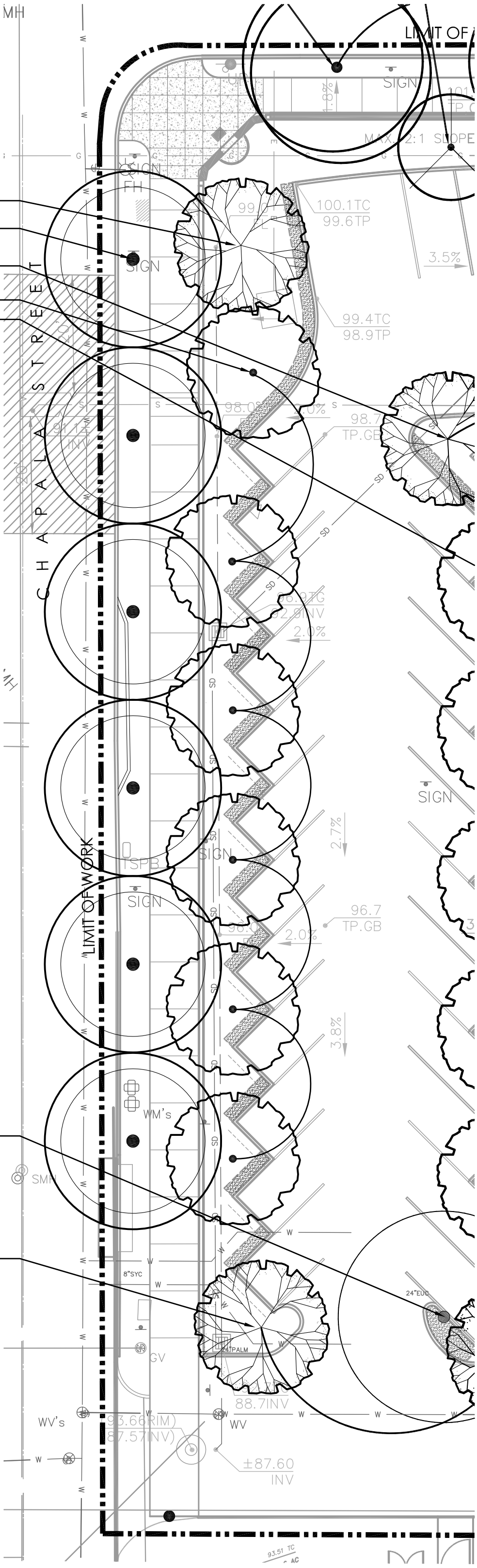

- 1-JAC MIM
48" BOX STD.
- 6-CED FIS
- 2-JAC MIM
36" BOX STD.
- 6-OLE SWA
- 5-OLE SWA

EMON EUCALYPTUS
P.I.P. REFER TO TREE
PROTECTION PLAN

- 2-JAC MIM
36" BOX STD.

CHAPALA STREET

LIMIT OF WORK

LIMIT OF

SIGN

MAX. 2:1 SLOPE

3.5%

100.1TC
99.6TP

99.4TC
98.9TP

98.7
TP.GE

96.9TC
92.9INV

2.0%

SIGN

96.7
TP.GB

2.0%

3.8%

WM's

WV's

3.66 RIM
7.57 INV

88.7INV

±87.60
INV

93.51 TC
AC

MH

FM

SMH

W

W

W

W

W

W

W

W

W

W

W

W

W

M

M

M

M

M

M

M

M

M

M

M

M

M

M

M

M

M

M

M

M

M

M

M

M

M

M

M

M

M

M

M

M

M

M

M

M

M

M

M

M

M

M

M

M

M

M

M

M

M

M

M

M

M

M

M

M

M

M

M

M

M

M

M

M

M

M

M

M

M

M

M

M

M

M

M

M

M

M

M

M

M

M

M

M

M

M

M

M

M

M

M

M

M

M

M

M

M

M

M

M

M

M

M

M

M

M

M

M

M

M

M

M

M

M

M

M

M

M

M

M

M

M

M

M

M

M

M

M

M

M

M

M

M

M

M

M

M

M

M

M

M

M

M

M

M

M

M

M

M

M

M

M

M

M

M

M

M

M

M

M

M

M

M

M

M

M

M

M

M

M

M

M

M

M

M

M

M

M

M

M

M

M

M

M

M

M

M

M

M

M

M

M

M

M

M

M

M

M

M

M

M

M

M

M

M

M

M

M

M

M

M

M

M

M

M

M

M

M

M

M

M

M

M

M

M

M

M

M

M

M

M

M

M

M

M

M

M

M

M

M

M

M

M

M

M

M

M

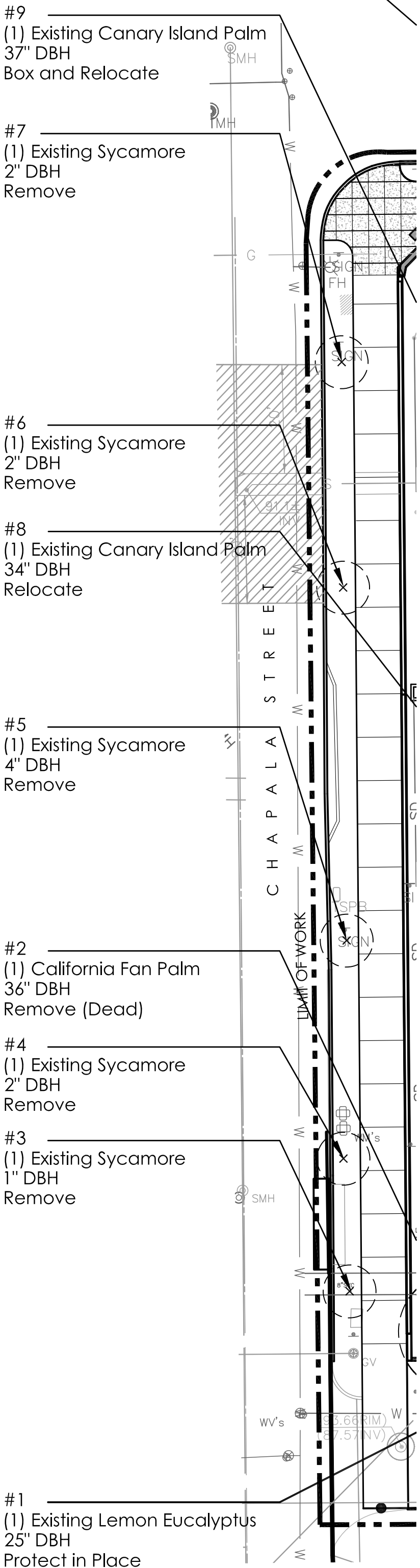

#9
 (1) Existing Canary Island Palm
 37" DBH
 Box and Relocate

#7
 (1) Existing Sycamore
 2" DBH
 Remove

#6
 (1) Existing Sycamore
 2" DBH
 Remove

#8
 (1) Existing Canary Island Palm
 34" DBH
 Relocate

#5
 (1) Existing Sycamore
 4" DBH
 Remove

#2
 (1) California Fan Palm
 36" DBH
 Remove (Dead)

#4
 (1) Existing Sycamore
 2" DBH
 Remove

#3
 (1) Existing Sycamore
 1" DBH
 Remove

#1
 (1) Existing Lemon Eucalyptus
 25" DBH
 Protect in Place