

## CITY OF SANTA BARBARA WATERFRONT DEPARTMENT

### MEMORANDUM

**Date:** February 15, 2018  
**To:** Harbor Commission  
**From:** Scott Riedman, Waterfront Director  
**Subject:** **Extension of Office Lease Agreement with the National Oceanic and Atmospheric Administration**

---

#### **RECOMMENDATION:**

That Harbor Commission recommend City Council approve a three-year extension to the existing five-year lease agreement with the National Oceanic and Atmospheric Administration for office space located at 113 Harbor Way, at a rent of \$1,396.68 per month.

#### **DISCUSSION:**

In June 2013, the National Oceanic and Atmospheric Administration relocated the majority of their local Channel Islands National Marine Sanctuary (CINMS) offices to a new building on the University of California Santa Barbara campus. However, in addition to their vessels currently in the Santa Barbara Harbor, CINMS currently maintains two offices and storage space totaling 452 square feet and wished to extend, by three years, the current five-year lease agreement. All terms and conditions of the current five-year lease agreement remain the same with the proposed three-year extension.

The basic terms of the proposed lease are as follows:

- **Term:** Three year extension to the existing 5-year lease;
- **Base Rent:** \$1,396.68 per month (\$3.09 / square foot);
- **Percentage Rent:** N/A; and,
- **Annual Rent Adjustment:** N/A

A copy of the proposed lease is available for review at the Waterfront Department Administration office.

Attachment: Lease Area

Prepared by: Brian J. Bosse, Waterfront Business Manager



FIRST FLOOR PLAN

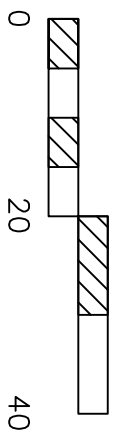

Scale (Feet)

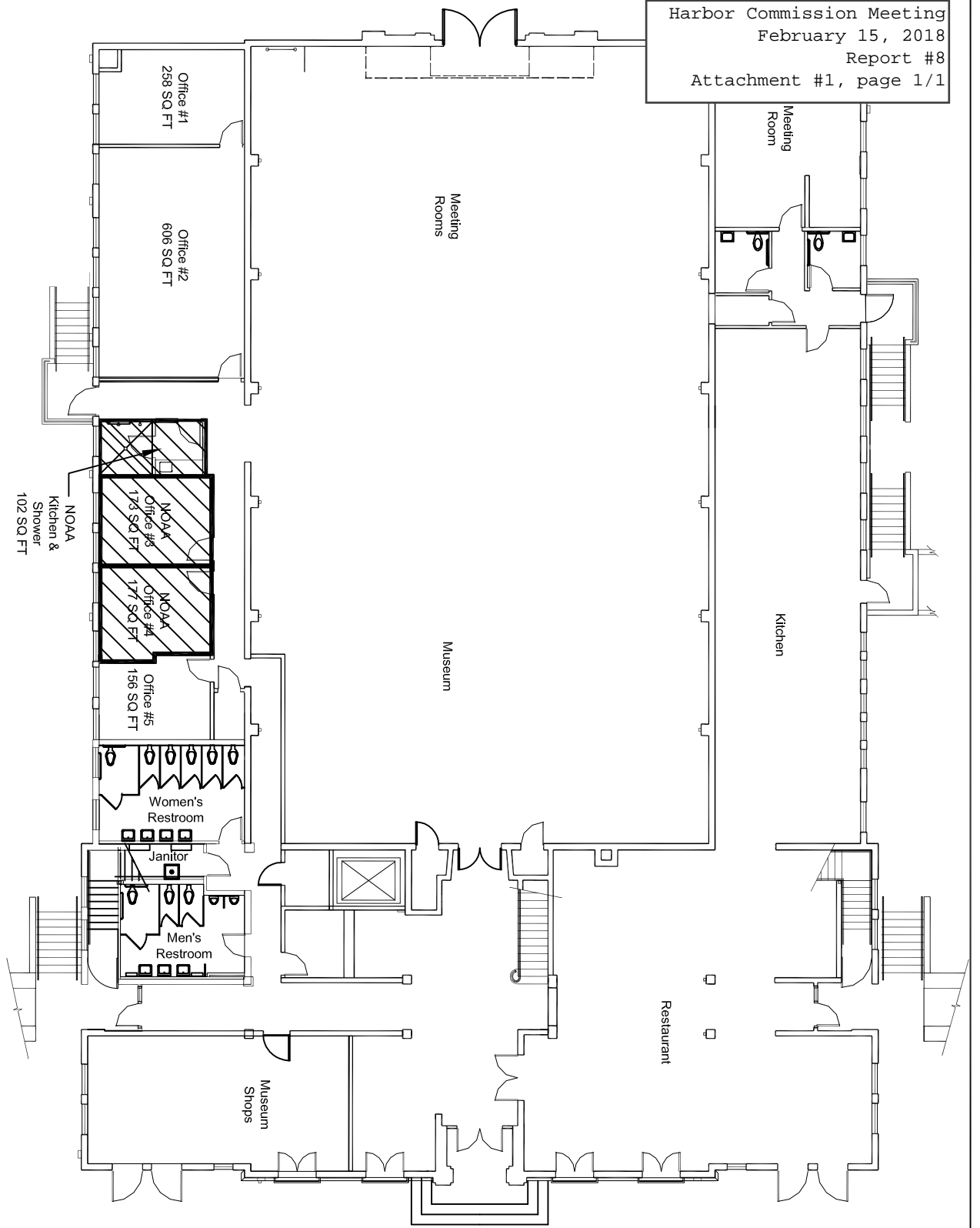

NOAA OFFICES  
 LEASE AREA

Office #3	173 SQ FT
Office #4	177 SQ FT
Kitchen / Shower	102 SQ FT
<b>Total</b>	<b>452 SQ FT</b>

REVISIONS

NOAA Offices  
 Exhibit "A"

DATE	1-20	APPROVED BY	K. Treiberg, Facilities Manager	DRAWN BY	T. Lawler
DATE	6/2/2013	APPROVED BY	113 Harbor Way	DRAWING NO.	1130-024
City of Santa Barbara					
Waterfront Department					
					SHEET NO.
					1 of 2