



City of Santa Barbara
Airport Department

DATE: July 16, 2014
TO: Airport Commission
FROM: Hazel Johns, Airport Director 
SUBJECT: Lease Agreement – Swiss Designs Construction

RECOMMENDATION:

That Commission approve and authorize the Airport Director to execute a month-to-month Lease Agreement with Remo Schluep, a Sole Proprietorship, dba Swiss Designs Construction for 11,100 square feet of land, at 6195 Francis Botello Road, at the Santa Barbara Airport, effective August 1, 2014, for a monthly rental of \$1,554.

DISCUSSION:

The subject Premises is located north of Hollister Avenue in an Airport Industrial (AI-1) zone.

Swiss Designs Construction is a Santa Barbara company specializing in stone paver installations for patios and driveways. The company has been operating in the Santa Barbara area for nearly 30 years. The yard will be used for the storage of pavers, equipment, and vehicles, and the temporary sorting of recyclable materials removed from its construction jobs. The use conforms to existing zoning.

The proposed monthly rental of \$1,554 is based on a rate of \$.14 per square foot and is comparable to other land on the Airport for similar use and in similar condition.

The proposed Lease Agreement has been reviewed and determined to be exempt from environmental review.

PREPARED BY: Business & Property Division

ATTACHMENT: Map

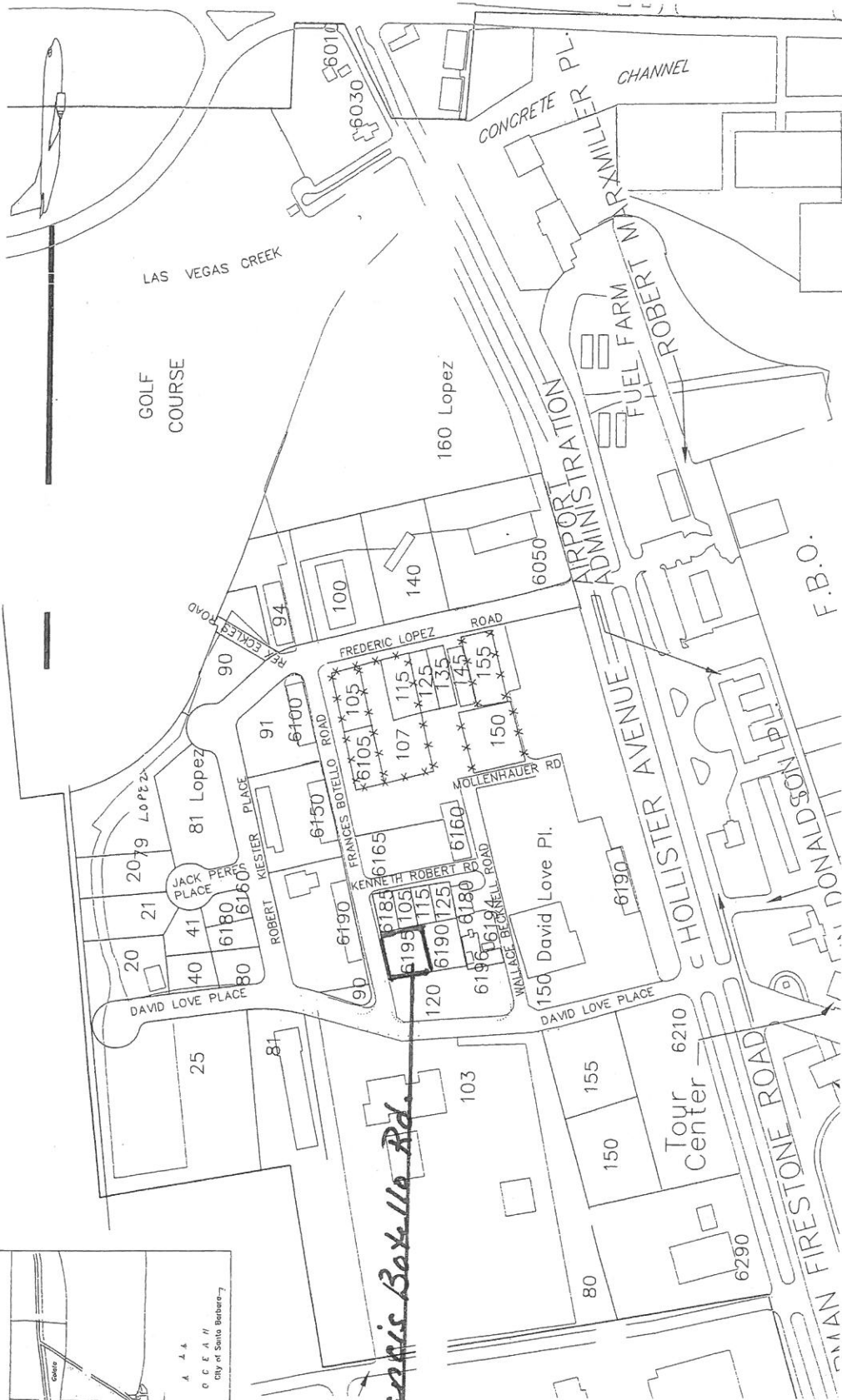
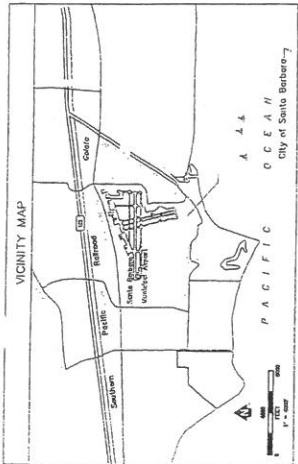

6195 Francis Botello Rd.

PROJ. NO. _____
 SHT. 1 OF 1 SHTS.
 DWG. NO. C-5-B04exb

SCALE
 VERT. N.T.S.
 HOR. N.T.S.

CITY OF SANTA BARBARA MUNICIPAL AIRPORT
Northside Address Layout Plan

DESCRIPTION	DATE	APPROVED	REVISIONS
DESIGN L.B.			
DRAWN L.B.			
CHECKED			
F.D.B.K. NO.			
PAGE			
ATLAS			