

TRAFFIC

<u>NUMBER</u>	<u>TITLE</u>	<u>NUMBER</u>	<u>TITLE</u>
T-01.0	TRAFFIC SIGNAL GENERAL NOTES	T-03.1	CROSSWALK DETAILS - CONTROLLED CROSSINGS
T-01.1	TRAFFIC SIGNAL STANDARD EQUIPMENT	T-03.2	CROSSWALK DETAILS - UNCONTROLLED CROSSINGS
T-02.0	SIGN INSTALLATION GENERAL NOTES	T-04.1	LANE CLOSURE (MERGE CONDITION)
T-02.1	SIGN POST INSTALLATION ON SQUARE TUBE	T-04.2	LANE CLOSURE (MERGE CONDITION) - FAR SIDE OF INTERSECTION
T-02.2	SIGN POST INSTALLATION ON STREET LIGHT POLES	T-04.3	STREET CLOSURE - ALL WAY STOP SIGN CONDITION
T-02.3	SIGN HEIGHTS AND LATERAL CLEARANCES	T-04.4	STREET CLOSURE NON STOP SIGN CONDITION
T-03.0	PAVEMENT MARKINGS GENERAL NOTES	T-04.5	WORK ZONE - CENTER OF ONE WAY STREET



TRAFFIC TABLE OF CONTENTS

REV. DATE: 12/23	DETAIL: T-00.0
APPROVED: <i>Brian D'Amico</i>	
CITY ENGINEER	
12/20/23	
DATE	

NOTES:

1. Contact the Traffic Engineering Division for traffic signal turn on procedures.
2. Any request to place a traffic signal in Dark or Flashing Mode must be approved by the Traffic Engineering Division.
3. Any new or modified traffic signal conductors shall be multi conductor, and shall include replacement of all conductors affected.
4. Standard Street Crossing shall be 2 x 3" PVC or HDPE SDR-II conduits with a minimum one Green #8 THHN/THWN Copper Stranded Bare Wire and a 2500 lb Mule Tape.
5. Cap all un-used conduits with a TYCO Jackmoon Expandable Plug or approved equal.
6. Traffic loop detectors shall be replaced within two weeks unless approved by the Inspector. Advanced traffic loop detectors shall be replaced in kind. Stop bar loop detectors shall be replaced with Caltrans C/D combination loop detectors. Installations shall be done per Caltrans Standard Specifications and Plans, Latest Edition.
7. During construction, all traffic signal heads shall be visible as required by the CAMUTCD unless approved by the Traffic Engineering Division.
8. Signal cable shall be used for any new or replacement of traffic signal wiring.
9. All work shall comply with Caltrans Standard Specifications and Plans, Latest Edition.



TRAFFIC SIGNAL GENERAL NOTES

REV. DATE: 12/23 | DETAIL: T-01.0

APPROVED: 
CITY ENGINEER
12/20/23
DATE

STANDARD EQUIPMENT NOTES:

1. The City follows the latest Caltrans Standard Details and Specifications, except as noted below. Please contact the Traffic Engineering Division for standard equipment specifications for the following:

- Accessible Pedestrian Systems (APS)
- Battery Backup Systems
- Cabinets
- Controllers
- Emergency Vehicle Preemption
- Fiber Optic Switches
- Heads and LED's
- Paint color and products
- Pan/tilt/zoom Cameras
- Pull Boxes and Lids
- Quad Encoders
- Video Detection Systems



TRAFFIC SIGNAL STANDARD EQUIPMENT

REV. DATE: 12/23 | DETAIL: T-01.1

APPROVED: *Brian D'Amico*
CITY ENGINEER
12/20/23
DATE

NOTES:

1. Sign posts called for replacement shall include new signs, unless approved by the Traffic Engineering Division.
2. The following sheeting is acceptable for signs:
 - Warning Signs (S, SW, and W Series), Regulatory (R series, except parking signs), and Directional (D series) shall be diamond grade sheeting with overlay.
 - Parking signs may be engineering grade with overlay.
3. All pedestrian and school signs shall be florescent yellow green (FYG).
4. All non-pedestrian and school warning signs shall be " flourescent yellow" in color.
5. Contact the Traffic Engineering Division for custom sign layouts.



SIGN INSTALLATION

GENERAL NOTES

REV. DATE: 12/23 | DETAIL: T-02.0

APPROVED: 

CITY ENGINEER
12/20/23

DATE

FOUNDATION DETAIL FOR SQUARE STEEL POST MOUNTING

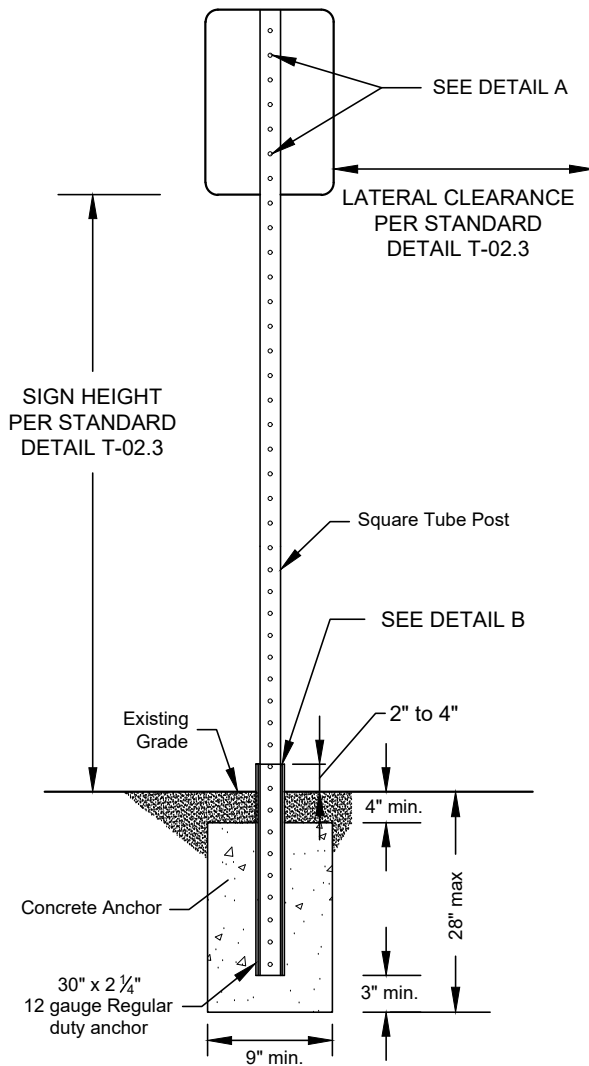

SAND (BEACHES)

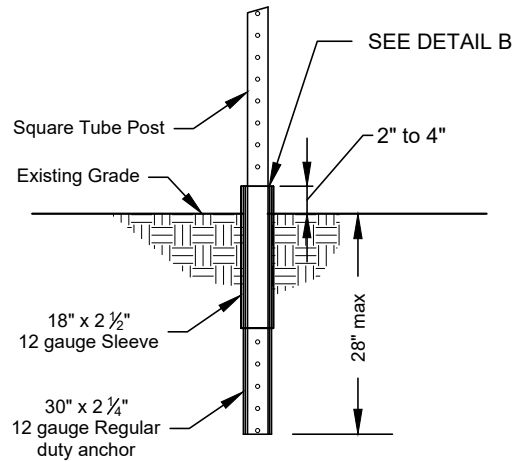

WITHOUT SIDEWALK

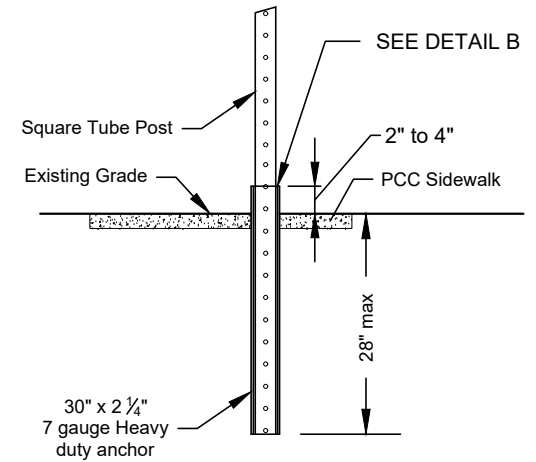

WITH SIDEWALK

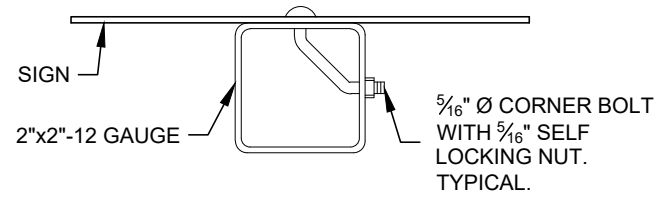

DETAIL A - SIGN MOUNTING

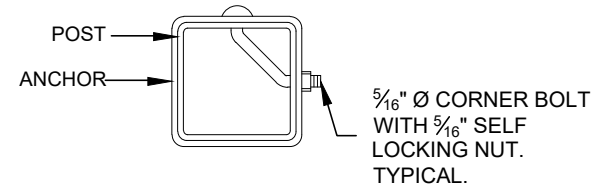

DETAIL B - ANCHOR ASSEMBLY



SIGN POST INSTALLATION SQUARE TUBE

REV. DATE: 12/23 DETAIL: T-02.1

APPROVED: *Brian D'Amico*

CITY ENGINEER

12/20/23

DATE

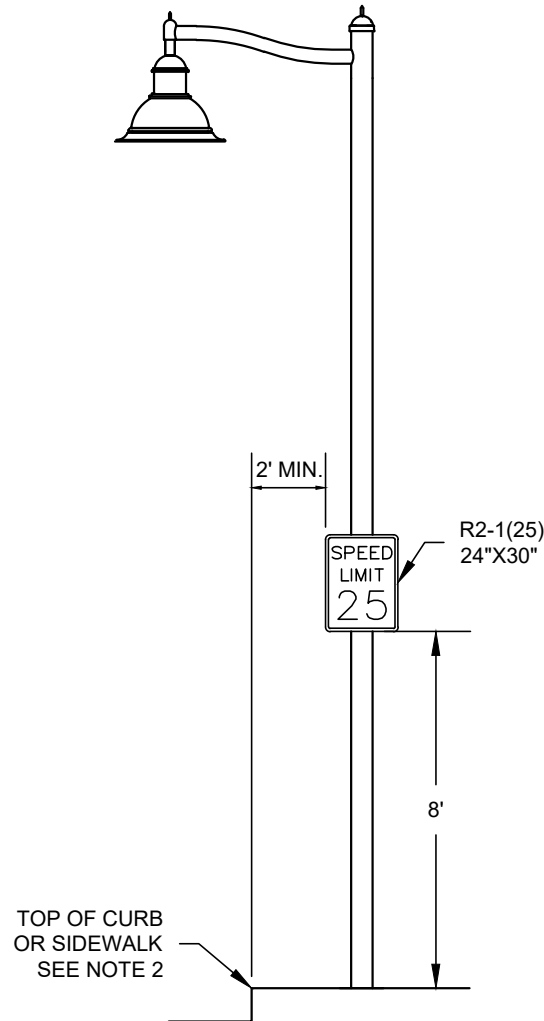
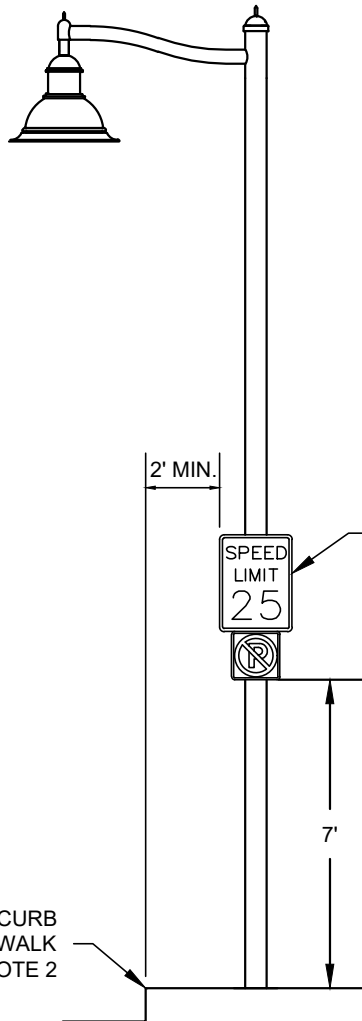

NOTES:

1. Secondary sign mounted below another sign shall not be installed less than 7 feet in height.
2. In cases where curbs or sidewalks do not exist, height of signs shall be measured from road surface.
3. A minimum offset of 1 foot may be used where sidewalk width is limited or where existing poles are close to the curb.



SIGN INSTALLATION ON STREET LIGHT POLES

REV. DATE: 12/23 | DETAIL: T-02.2

APPROVED:

Brian D. Allen

CITY ENGINEER

12/20/23

DATE

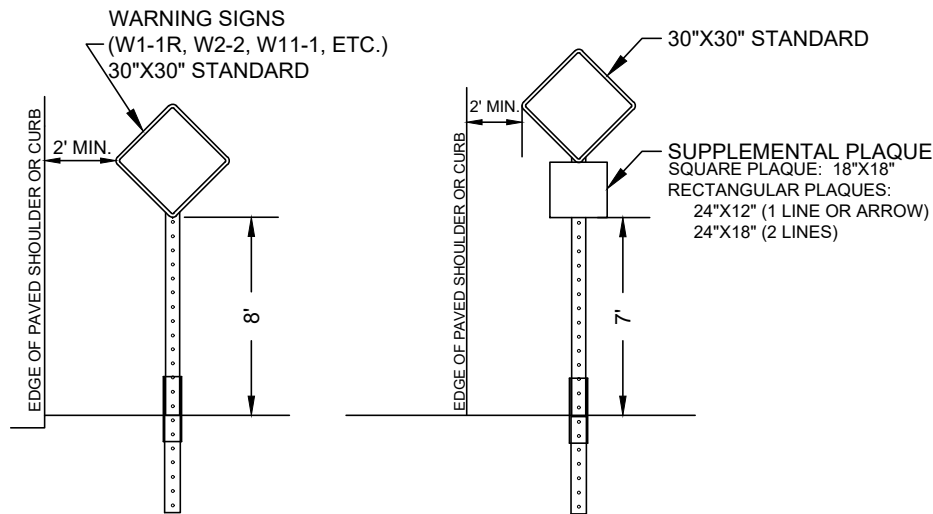

NOTES:

1. Secondary sign mounted below another sign shall not be installed less than 7 feet in height.
2. In cases where curbs or sidewalks do not exist, height of signs shall be measured from road surface.
3. A minimum offset of 1 foot may be used where sidewalk width is limited or where existing poles are close to the curb.

STANDARD LATERAL & VERTICAL CLEARANCES

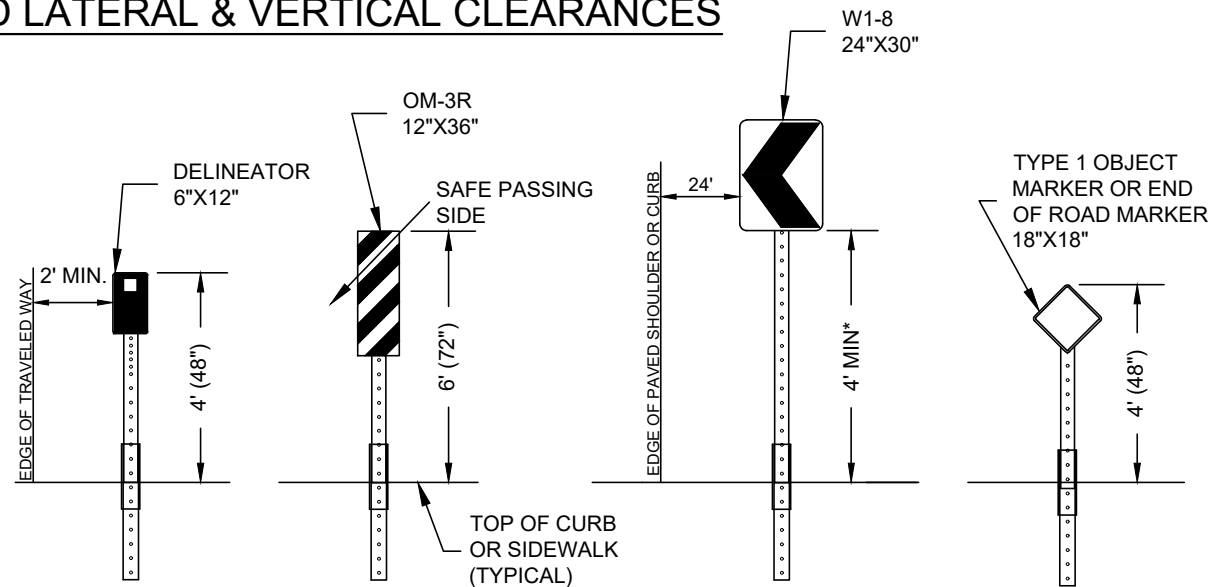

* Coordinate with traffic engineering staff for exact height of W1-8 signs.

LATERAL & VERTICAL CLEARANCES (SPECIAL CONDITIONS)



SIGN HEIGHTS AND LATERAL CLEARANCES

REV. DATE: 12/23 | DETAIL: T-02.3

APPROVED: *Brian D. Allen*

CITY ENGINEER

12/20/23

DATE

NOTES:

1. Pavement markings affected by trenching or construction equipment shall be replaced in kind.
The limit of replacement shall include entire lines, letters, and symbols.
2. Pavement markings on resurfaced streets (grind and overlay, slurry seal, etc) shall be replaced with enhanced "wet night" look thermoplastic. (See Caltrans 84-2.03C)
3. Refer to Caltrans Standard Specifications Section 84, Latest Edition.



PAVEMENT MARKING

GENERAL NOTES

REV. DATE: 12/23 | DETAIL: T-03.0

APPROVED: 

CITY ENGINEER

12/20/23

DATE

CONTROLLED -(Stop or Signal) Basic Crosswalk, Stop Bar, and Lead Up

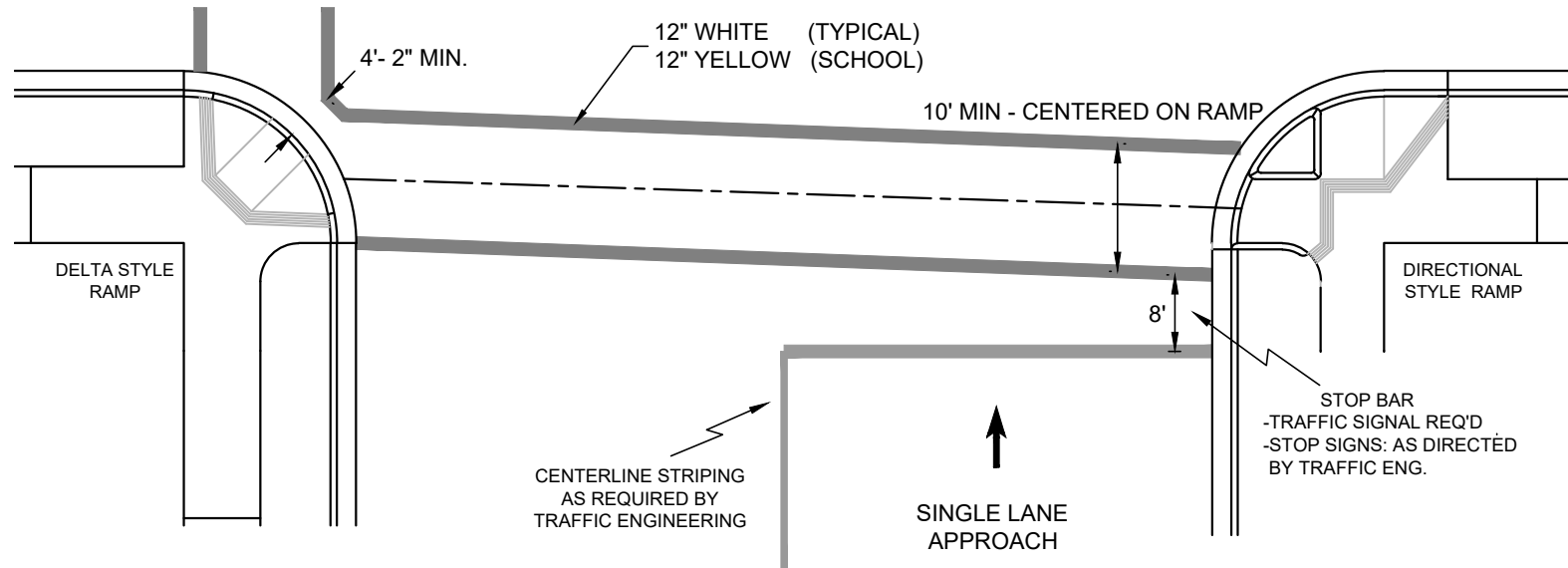

CONTROLLED -(Stop or Signal) Ladder (High Visibility) Crosswalk, Stop Bar, and Lead Up

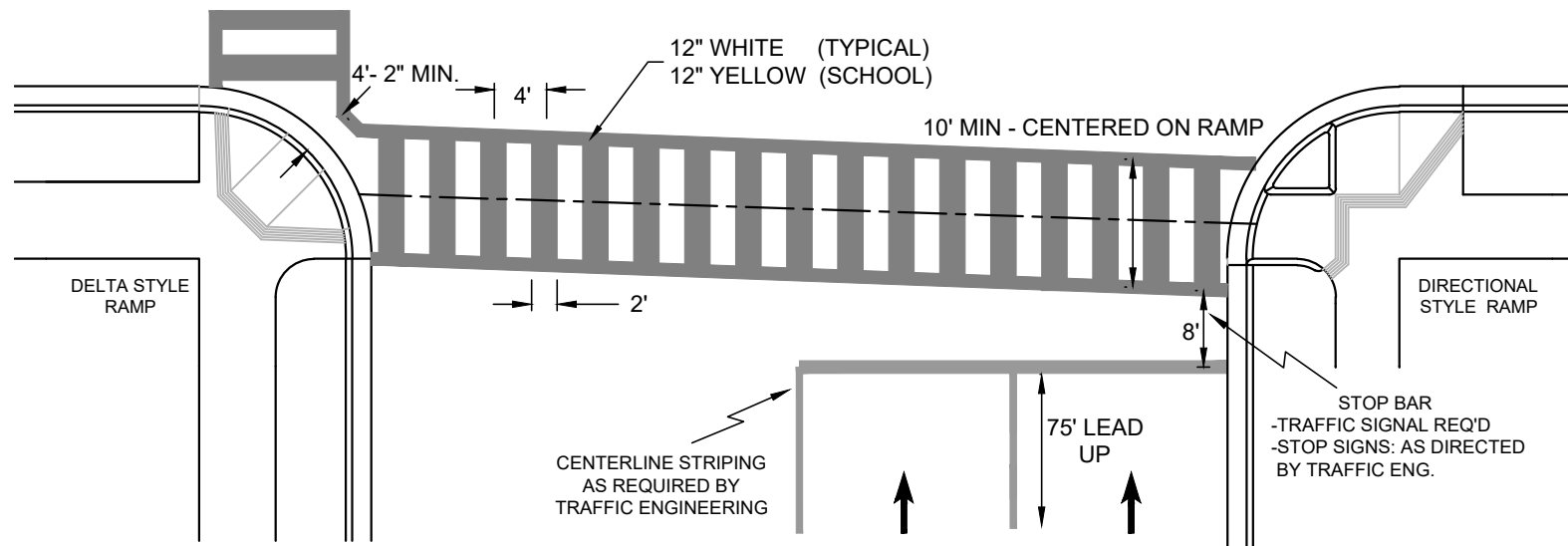

CROSSWALK DETAILS

CONTROLLED CROSSINGS

REV. DATE: 12/23 DETAIL: T-03.1

APPROVED: *Brian D'Amico*
CITY ENGINEER
12/20/23
DATE

UNCONTROLLED - Continental Crosswalk

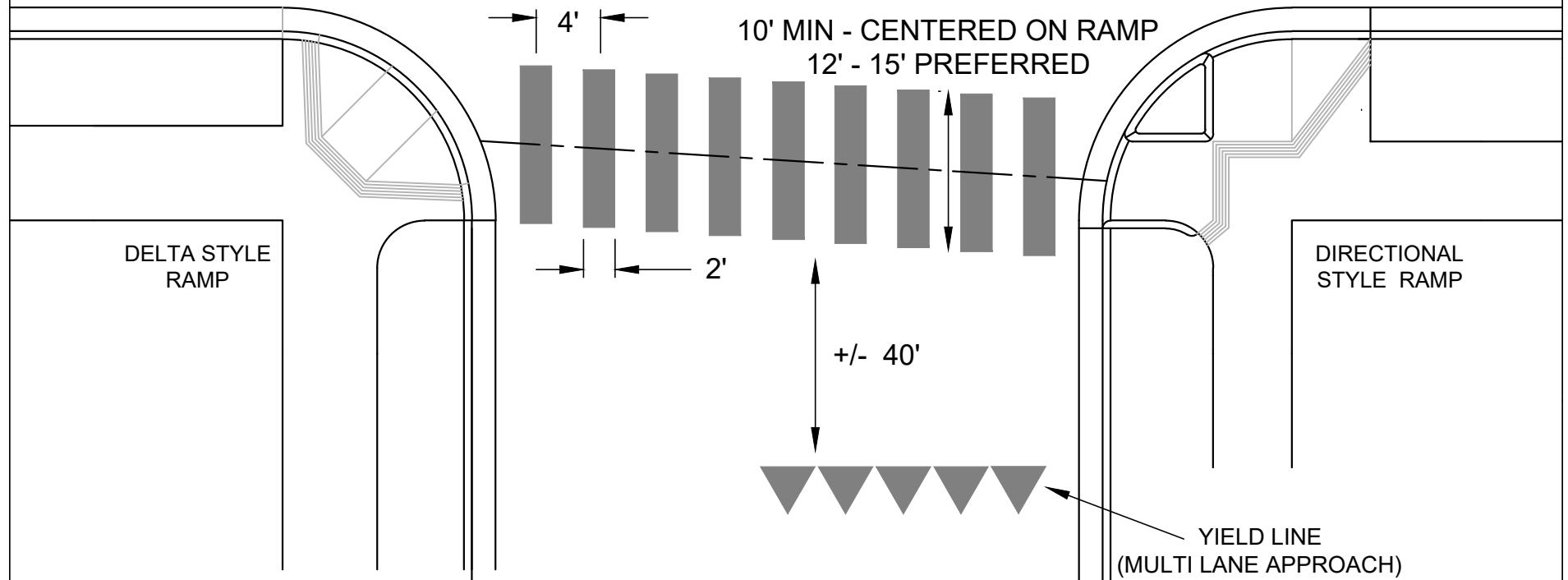

CROSSWALK DETAILS

UNCONTROLLED CROSSING

REV. DATE: 12/23 | DETAIL: T-03.2

APPROVED: *Brian D. Am*

CITY ENGINEER

12/20/23

DATE

USE LEFT SIDE SIGNS
ON ONE WAY STREETS
AND WHERE MEDIANS
PRESENT.



C-20

OR



W4-2



W20-1(CA)

USE CAUTION-SIDE
STREET SIGHT LINES

NOTE:
SIGHT LINES MUST BE MAINTAINED.
IF YOU ARE UNABLE TO DO SO,
A FLAGGER MUST BE USED.

WORK ZONE

ARROW
BOARD
(REQ'D)

BUFFER (OPTIONAL)

TAPER

SIGN
SPACING

SIGN
SPACING



W20-1(CA)



C-20

OR



W4-2

Speed (mph)	Channelized Spacing (feet)	Sign Spacing (feet)	Taper Length* (feet)
25	25	100	150
30	30	250	205
35	35	250	267
40	40	250	450
45	45	350	500

*FOR 10-FOOT LANE



LANE CLOSURE MERGE CONDITION

REV. DATE: 12/23 DETAIL: T-04.1

APPROVED: *Brian D. Am...*

CITY ENGINEER

12/20/23

DATE

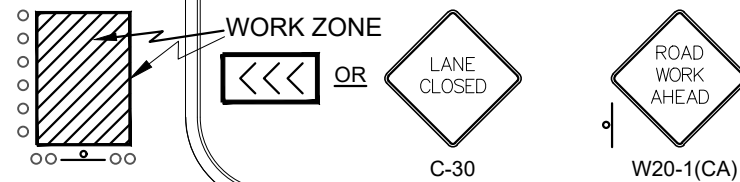

USE LEFT SIDE SIGNS
ON ONE WAY STREETS
AND WHERE MEDIANS
PRESENT.

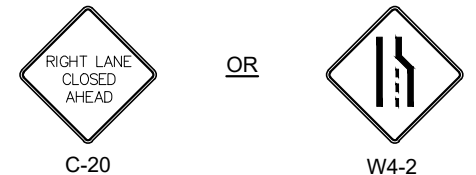
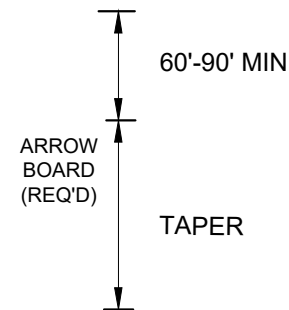
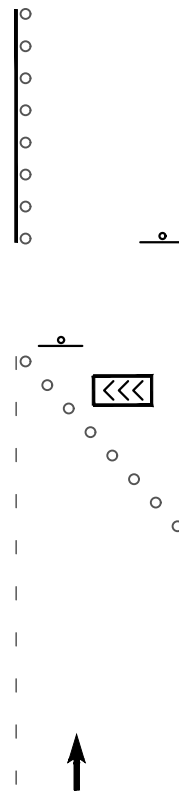
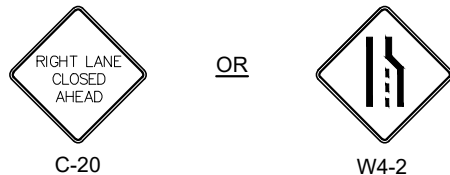

Speed (mph)	Channelized Spacing (feet)	Sign Spacing (feet)	Taper Length* (feet)
25	25	100	150
30	30	250	205
35	35	250	267
40	40	250	450
45	45	350	500

* FOR 10-FOOT LANE



LANE CLOSURE (MERGE) FAR SIDE OF INTERSECTION

REV. DATE: 12/23 | DETAIL: T-04.2

APPROVED: *Brian D'Amico*

CITY ENGINEER

12/20/23

DATE

WORK ZONE

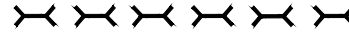
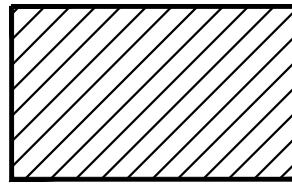

R11-2



R11-2

PROVIDE DETOUR
SIGNS



STOP

PROVIDE DETOUR
SIGNS

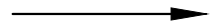

STOP



ALL WAY

STOP

STOP



ALL WAY



STREET CLOSURE

ALL WAY STOP CONDITION

REV. DATE: 12/23 | DETAIL: T-04.3

APPROVED: *Brian D'Amico*

CITY ENGINEER

12/20/23

DATE

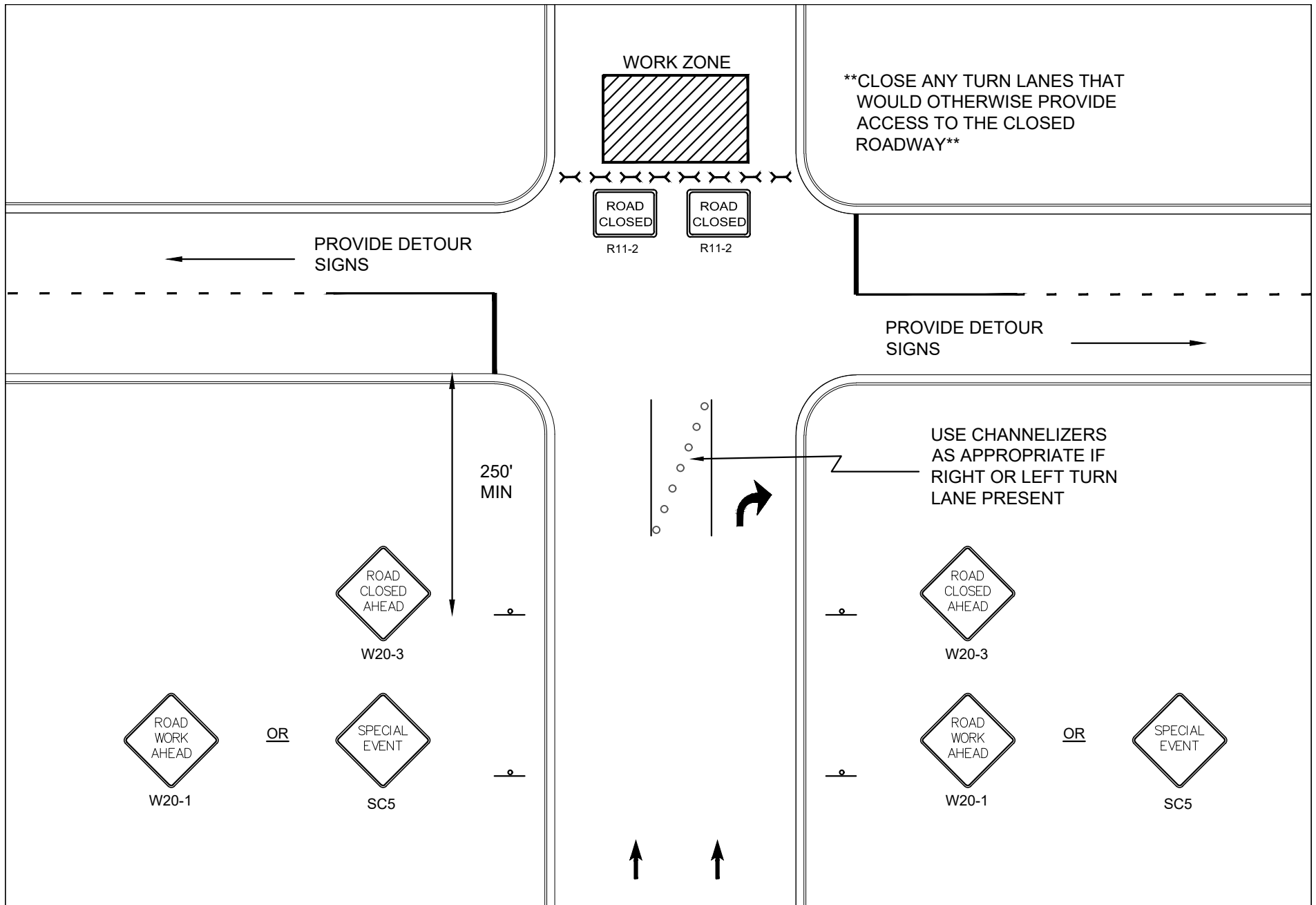

STREET CLOSURE

NON STOP CLOSURE CONDITION

REV. DATE: 12/23 | DETAIL: T-04.4

APPROVED: *Brian D'Amico*

CITY ENGINEER

12/20/23

DATE

FLASHING ARROW BOARD (REQ'D)
AND BLOCKING VEHICLE

Speed (mph)	Channelized Spacing (feet)	Sign Spacing (feet)	Buffer (feet)	Taper Length (feet)
25	25	100	100	75
30	30	250	100	105



W20-1(CA)

WORK ZONE

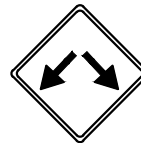
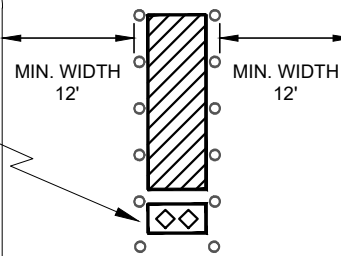

W12-1

BUFFER

TAPER
(NO PARKING)

SIGN SPACING



W20-1(CA)



WORK ZONE

CENTER OF ONE WAY STREET

REV. DATE: 12/23 | DETAIL: T-04.5

APPROVED: *Brian D'Amico*

CITY ENGINEER

12/20/23

DATE